

PD-32: SOUTH DEVELOPMENT STANDARDS



DOUGLAS PARK
LONG BEACH

Adopted by the Long Beach City Council on
December 21, 2004
Ordinance No. C-7958

Amended on October 13, 2009
Ordinance No. ORD-09-0029

Amended on April 17, 2018
Ordinance No. ORD-18-0009

Amended on May 19, 2020
Ordinance No. ORD-20-0019

Amended on September 29, 2020
Ordinance No. ORD-XX-XXXX



CITY OF LONG BEACH

ORIGINALLY PREPARED IN 2004 BY:

J O H N S O N F A I N

COLLABORATORS:

CLARK & GREEN ASSOCIATES

ALTOON + PORTER ARCHITECTS

MCCLAR AND VASQUEZ
EMSIEK & PARTNERS

TABLE OF CONTENTS

STANDARDS - DIVISION I

INTRODUCTION

DEVELOPMENT STANDARDS 3

INTENT 4

General Urban Design Goals 4

Streets 4

Commercial Uses / Mixed Uses 5

DESIGN REVIEW PROCESS 6

STANDARDS - DIVISION II

ESTABLISHING THE FRAMEWORK

Sub Areas 12

Street Hierarchy 14

Bike Paths 16

Build-To Lines 18

View Corridors 18

Generalized Height Zones 20

Stepbacks 22

STANDARDS - DIVISION III

COMMERCIAL/INDUSTRIAL SUB AREA STANDARDS

COMMERCIAL/ INDUSTRIAL SUB AREA STANDARDS	27
Permitted Uses	27
Definitions	28
Minimum Lot Area	38
Setbacks	38
General Screening Requirements	40
On-Grade Parking Garages	40
Surface Parking Lots	40
Mechanical Equipment on Rooftops	40
General Requirements for the Design of Buildings	41
Accessory Structures	41
Utility Meters Screening	42
Undergrounding of Utilities	42
Off-street Parking and Loading Requirements	42
Landscaping Requirements	42
Fences and Garden Walls	42
Signs	42
Right-of-way Dedications and Improvements	42
SPECIAL DEVELOPMENT STANDARDS	43
SUB AREA 7	43
Mixed-Use Overlay Zone	43
Facade Articulation	45
Building Stepbacks	47
Vehicular Driveway Access	47
SUB AREA 8	50
Sub Area 8A	50
Sub Area 8B	50
Continuous Building Edge/ Facade Articulation	50
Vehicular Driveway Access	50
Boeing Enclave Screening	50

STANDARDS - DIVISION IV

APPENDIX

APPENDIX

57

Master Street Tree Plan

57

LIST OF TABLES

Table 1 : Sub Area Use Classification	14
Table 2 : Uses in Commercial / Industrial Sub Areas	29
Table 3 : Permitted Lot Area in Commercial Sub Areas	38
Table 4 : Required Yard Setbacks between Buildings and Property Lines in Commercial Sub Areas	38
Table 5 : Required Yard Setbacks between Parking Lots and Property Lines in Commercial Sub Areas	39

LIST OF FIGURES

Figure 1 : Project Site and Vicinity Map	3
Figure 2 : Design Review Process	7
Figure 3 : Plan Boundary, Development Block & Street Grid	11
Figure 4 : Planning Sub Areas	13
Figure 5 : Street Hierarchy	15
Figure 6 : Bike Paths	17
Figure 7 : Build-To Lines & View Corridors	19
Figure 8 : FAA Height Contours	20
Figure 9 : Generalized Height Zones	21
Figure 10 : Step-Backs Diagram	23
Figure 11 : Sub Area 7	46
Figure 12 : Section Q-Q	48
Figure 13 : Section R-R	48
Figure 14 : Section A-A	49
Figure 15 : Section P-P	49
Figure 16 : Sub Areas 8A and 8B	51
Figure 17 : Section S-S	52
Figure 18 : Section T-T	52
Figure 19 : Master Street Tree Plan	59

S t a n d a r d s - D i v i s i o n I
i n t r o d u c t i o n

Development Standards

The development standards for Planned Development District 32 (PD-32) are intended to be consistent with the City of Long Beach Municipal Code (LBMC) except as otherwise noted. PD-32 is subdivided into two areas, one north of Cover Street and the other south. These development standards apply to PD-32: South. They are mandatory provisions that along with the Design Guidelines, EIR mitigation measures, conditions of approval, and the Development Agreement (DA) between McDonald Douglas Corporation, a wholly-owned subsidiary of The Boeing Company (Boeing) and the City will govern the development of the Plan Area within the City of Long Beach as defined in the Plan Boundary Map (see Figure 3 on page 11) unless a variance is obtained. They regulate areas such as land use, density, height, setbacks, streetwalls, view corridors, open space, parking/ loading and access.

The City of Long Beach may, at its discretion, grant variances to the development standards contained in this document where the enforcement would otherwise constitute an unreasonable limitation beyond the intent and purpose of the development standards, and where such a variance is consistent with the public health, safety and welfare.

Although every attempt has been made to make these development standards consistent with the LBMC, Long Beach Development Services shall resolve any conflicts between these two documents as part of the Design Review Process.



Figure 1 : Project Site and Vicinity Map

I n t e n t

In reviewing development proposals and land use issues, the City Council, Planning Commission, and Site Plan Review Committee shall be directed by following goals and objectives:

General Urban Design Goals

- The Master Plan shall acknowledge and appropriately respond to the varying contexts and adjacencies of the site – arterial boulevards, airport and airplane manufacturing, golf course and commercial and residential uses.
- The Master Plan shall create an Urban Design Framework that ensures the creation of a distinctive environment that creates long-term value and quality while being flexible enough to accommodate changes in the economy and real estate market. The urban design shall be based on a framework of proven historical patterns and precedents found in Long Beach’s distinctive and historic neighborhoods.
- A sense of place shall be created with clearly defined street hierarchy and character. The majority of Long Beach streets are laid out in a rectilinear grid pattern, which is appropriate to creating compact, walkable districts and neighborhoods.
- The master plan shall establish pedestrian orientation and human scale by limiting block sizes to those based on historical patterns and precedent:

Streets

- Design streets as places of shared use. Design streets as public open space to promote pedestrian orientation, sociability and safety. Street Right-of-Ways should be consistent with the minimum standards set forth in the Long Beach Municipal Code (LBMC table 47-1).
- Commercial streets should be scaled appropriately to accommodate pedestrian sidewalks and planted parkways. Major arterial streets with multiple traffic lanes should include landscaped features to maintain an appropriate human scale, and as a way to interface between uses.
- In accordance with the Master Street Tree Plan (see Division IV), street trees shall be located to provide shade for pedestrians, and provide appropriate scale and rhythm to the street (regular spacing and consistent alignment).
- Street trees, parkway treatments, gateways and other landscape elements shall reflect the character of the community’s most distinctive maturely landscaped streets (e.g., Ocean Boulevard in downtown Long Beach).

Commercial Uses / Mixed Uses

- Development should emphasize pedestrian orientation and the creation of a distinctive village-like urban environment that mitigates conflicts between proposed commercial uses.
- While carefully planning for the needs of vehicular circulation, emphasize a pedestrian friendly character with buildings located at front setbacks. Locate parking in structures or at the rear or side of buildings.
- Development should be appropriately scaled and based on compatibility with adjoining uses.

Design Review Process

This section of the PD-32: South Development Standards establishes the procedures and requirements for review of development and use permits, and shall be consistent with the LBMC. PD-32: South will have two entities, the Boeing (or its successor) Design Review Committee (DRC) and Long Beach Development Services (City), which will play a role in reviewing and permitting development proposals. These procedures are established in order to coordinate the review by the two entities.

The role of the DRC is strictly advisory, and its decisions shall not constitute implied City approval of a proposal. The Design Review Process with the City shall be governed by the Site Plan Review process contained in Division V of LBMC Chapter 21.25. The development standards contained in this document along with the design guidelines for the project shall be used by the City throughout the Site Plan Review process. Proposals not complying with these documents will be deemed unacceptable, and will be rejected.

While the City will strictly adhere to the requirements of the Site Plan Review process in the LBMC, the following provides a general guide to the applicant for the overall design review process, including special submittal requirements in addition to those in the LBMC.

Step 1 : Conceptual Site Plan Review

Applicant shall submit conceptual plans in accordance with the application filing requirements and instructions of the City of Long Beach Planning Permit Application to the DRC for an initial review of compliance with the PD-32: South Development Standards and Design Guidelines. Following such review, the DRC shall acknowledge conceptual approval of submittal in writing to the City prior to the applicant submitting plans to the City for conceptual site plan review in accordance with LBMC Section 21.25.502.B.

In order to maintain consistency with the maximum density thresholds stipulated in the Environmental Impact Report and the Development Agreement for the project, the initial written approval by the DRC shall include a summary of the commercial density (building area) approved and remaining to date. Both the written DRC approval and density summary shall be included as part of the initial submittal to the City for Site Plan Review.

Step 2 : Site Plan Review

Upon approval of conceptual site plan review by the City, the applicant shall submit a design package in accordance with the application filing requirements and instructions of the City of Long Beach Planning Permit Application to the DRC for review. Upon review and written acknowledgement of approval by the DRC to the City, the applicant

shall submit the design package to the City for site plan review in accordance with LBMC Section 21.25.502A.

Step 3 : Compliance Check

Applicant shall submit a final design development package (site plan and architecture) to the DRC for compliance check. The main purpose of this step is to confirm that project development is consistent with prior approvals and conditions prior to submitting for plan check with the City (construction ready documents). The City, at its discretion, may require submittal of this package for compliance with conditions of approval.

Step 4 : Record Set

Upon receipt of Building Permit, the applicant shall file a complete copy of the permitted plans bearing the City stamps of approval with DRC.

Federal Aviation Administration (FAA) Approval : During the design process, the applicant must complete and submit Form 7460-1 to the FAA. Prior to issuance of a building permit a copy of all written findings from the FAA regarding compliance with Part 77 height limit regulations related to the Long Beach Airport.

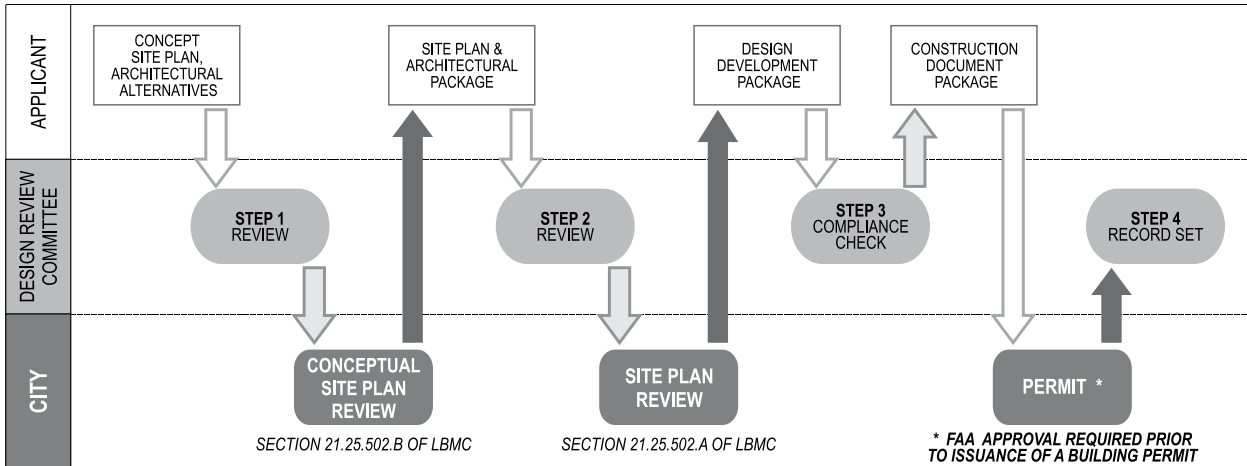
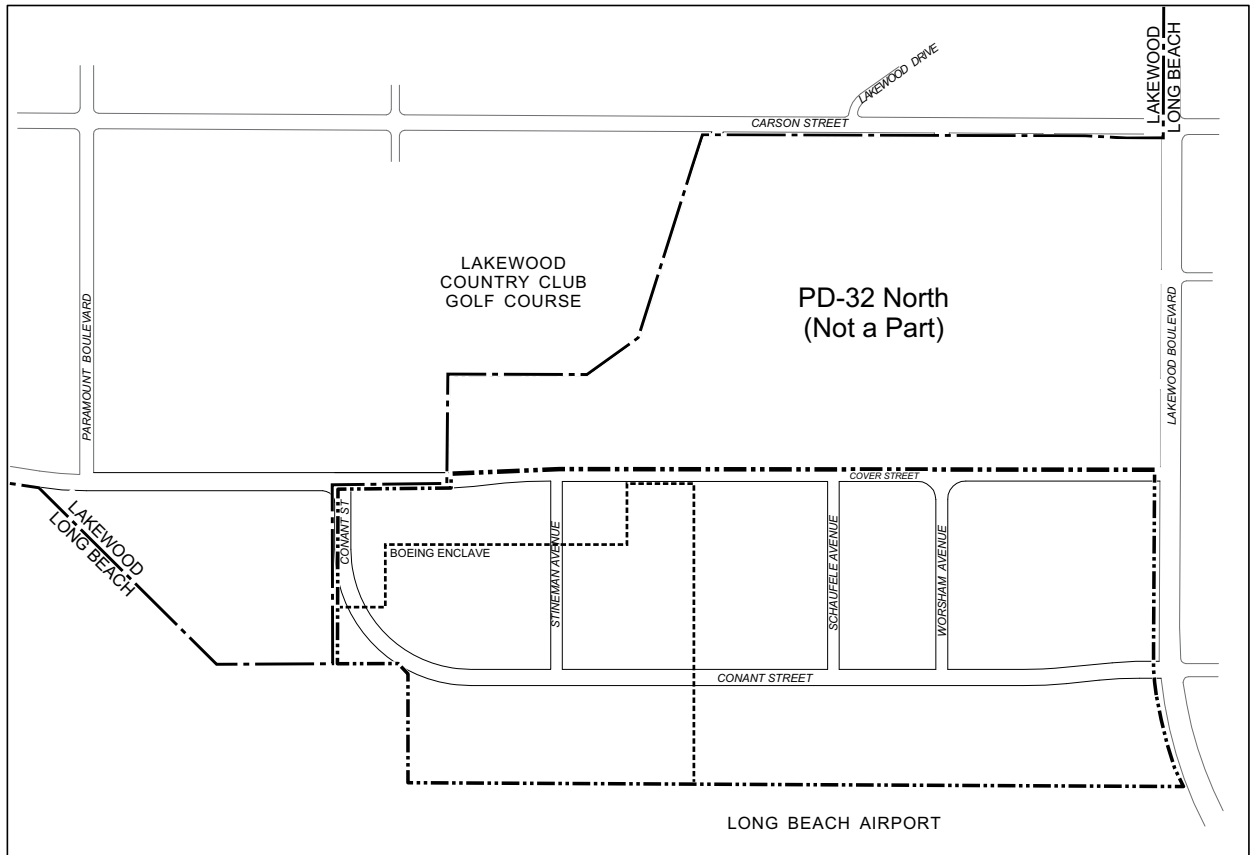

Figure 2 : Design Review Process

S t a n d a r d s - D i v i s i o n I I
E s t a b l i s h i n g t h e F r a m e w o r k

Establishing the Framework



- PD Boundary
- City Boundary
- Boeing Enclave
(Aircraft manufacturing will be allowed to continue in this sub area. Should Boeing declare its intention to abandon current aviation-related uses there, the sub area will be developed with uses consistent with sub area 8A)

Figure 3 : Plan Boundary, Development Block & Street Grid

P l a n n i n g S u b A r e a s

The PD-32 planning area is divided into sub areas as illustrated in Figure 4. PD-32:North is constituted of sub areas 1, 2, and 3. Sub areas 4, 5 and 6 are intentionally omitted designations and not used. Sub areas 7, 8A and 8B constitute PD-32:South, which is the focus of this document’s development standards and design guidelines. The intent and general standards for each of these sub areas are as follows:

Sub Areas

Sub Area 1 - PD-32:North

Sub Area 2 - PD-32:North

Sub Area 3 - PD-32:North

Sub Area 4 - Intentionally omitted

Sub Area 5 - Intentionally omitted

Sub Area 6 - Intentionally omitted

Sub Area 7

This sub area located immediately west of Lakewood Boulevard is intended as a primarily office “main street” commercial use zone along with R&D, some light industrial uses, aviation-related uses south of Conant Street, as well as hotel and retail uses to be located along Lakewood Boulevard and/ or Cover Street.

Along the south side of Cover Street, this sub area is the southern edge of a major “gateway” into the project, and will be subject to a Mixed Use Overlay zone. Such edge is envisioned as an active pedestrian edge with ground floor retail storefronts, pedestrian serving uses, hotel lobby/ public uses, and upper story commercial uses, along with special on-street parking provisions.

Sub Area 8A

In addition to the uses in Sub Area 7, this sub area is intended to include light industrial uses, certain aviation related uses south of Conant Street, manufacturing, and warehouse/ distribution (as an accessory use).

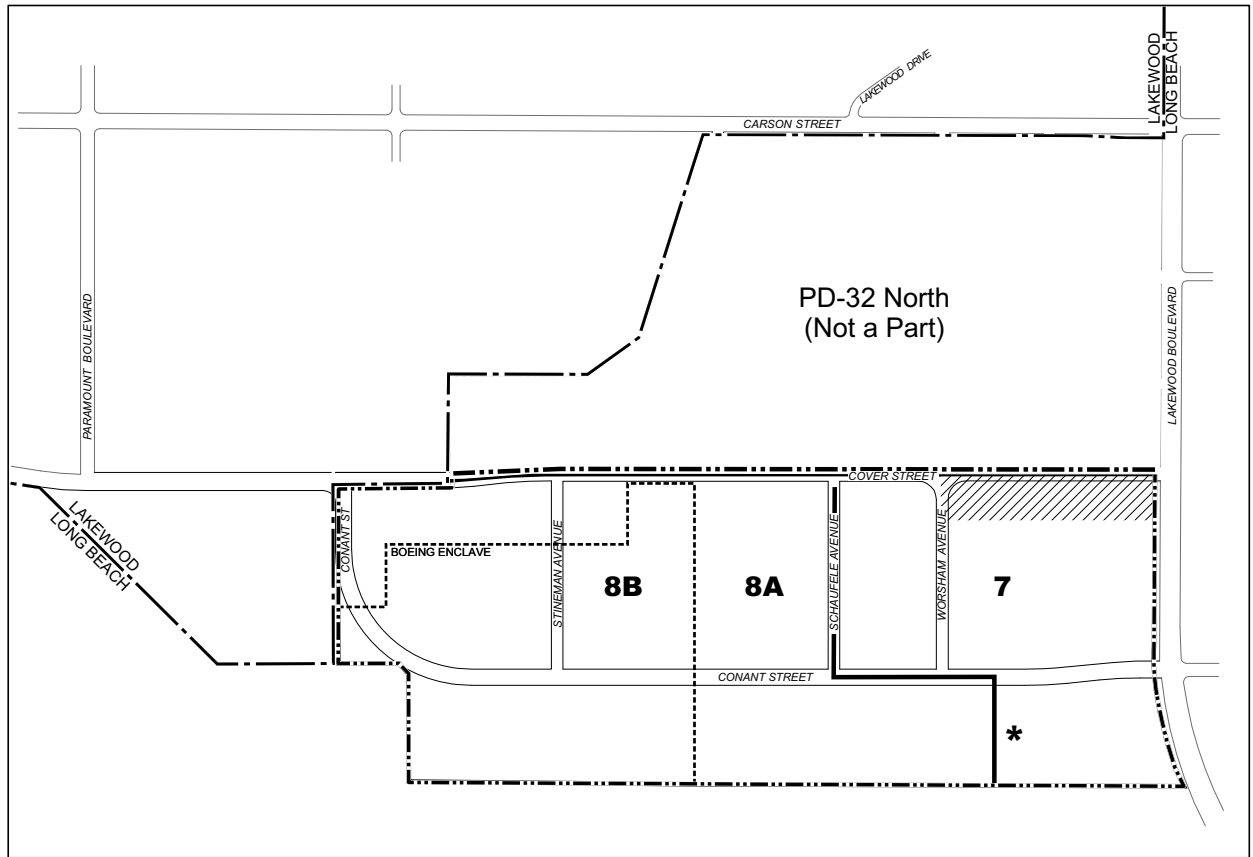

----- Boeing Enclave (8B)
(Aircraft manufacturing will be allowed to continue in this sub area. Should Boeing declare its intention to abandon current aviation-related uses there, the sub area will be developed with uses consistent with sub area 8A)

//// Mixed-Use Overlay Zone
(See special development standards for sub area 7)

* Approximate Sub Area Boundary
(Boundaries shown at locations other than at rights-of-way are general, and subject to Subdivision Map approval)

Figure 4 : Planning Sub Areas

Table 1 : Sub Area Use Classification

Sub Area	Use Classification
Sub Area 7	Office & "Main Street" Commercial, Hotel, Light Industrial*, Aviation-related Uses
Sub Area 8A	Office, Commercial, Light Industrial*, Aviation-Related Uses
Sub Area 8B	Continued Aircraft Manufacturing Support, Light Industrial*

*NOTE : Sub Areas shall generally be consistent with the applicable LBMC zoning districts listed above except as otherwise provided in this document.
 Accessory Use : As defined in LBMC*

Sub Area 8B



Also known as the Boeing Enclave, Sub Area 8B is a 43.5 acre area currently housing facilities related to aircraft production; ground support; receiving and delivery operations; customer operations; aircraft and avionic testing; and other related uses. This sub area will allow aircraft manufacturing, and aviation-related uses associated with the existing area to continue. Should current operations of this sub area be discontinued, the area will be developed with uses consistent with Sub Area 8A, at which time the Development Standards for Sub Area 8A shall govern.

Street Hierarchy

Public rights-of-way shall be reserved, dedicated and improved as provided for in LBMC Chapter 21.47 (Dedication, Reservation and Improvement of Public Rights-of-Way). Refer to Development Agreement (DA) between Boeing and the City for phasing and timing of improvements.

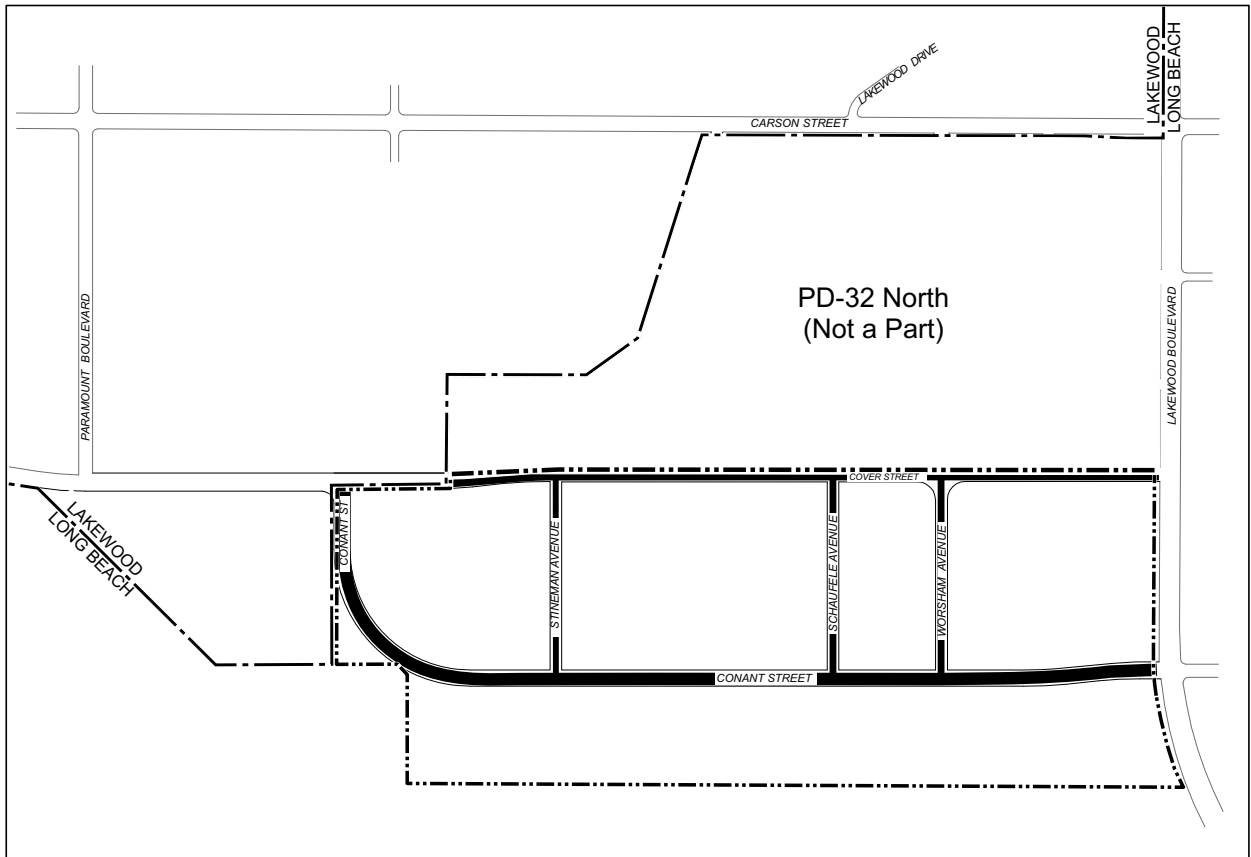
The Director of Public Works shall approve all proposed street improvements as part of the Site Plan Review Process, or as part of the approval for each Final Map.



-  Collector
-  Local Street

Note: All on-site infrastructure will be developed in accordance with the infrastructure phasing plan in the Development Agreement (DA).

This map represents the street infrastructure at full build-out but does not include any additional private roads that might be necessary for access to individual buildings within any development parcels.

Figure 5 : Street Hierarchy

Bike Paths

Improvements at Douglas Park will incorporate a network of bike paths. In the area of PD-32 : South, the length of Cover Street, Heineman Avenue, Steineman Avenue, and Worsham Avenue will include this feature.

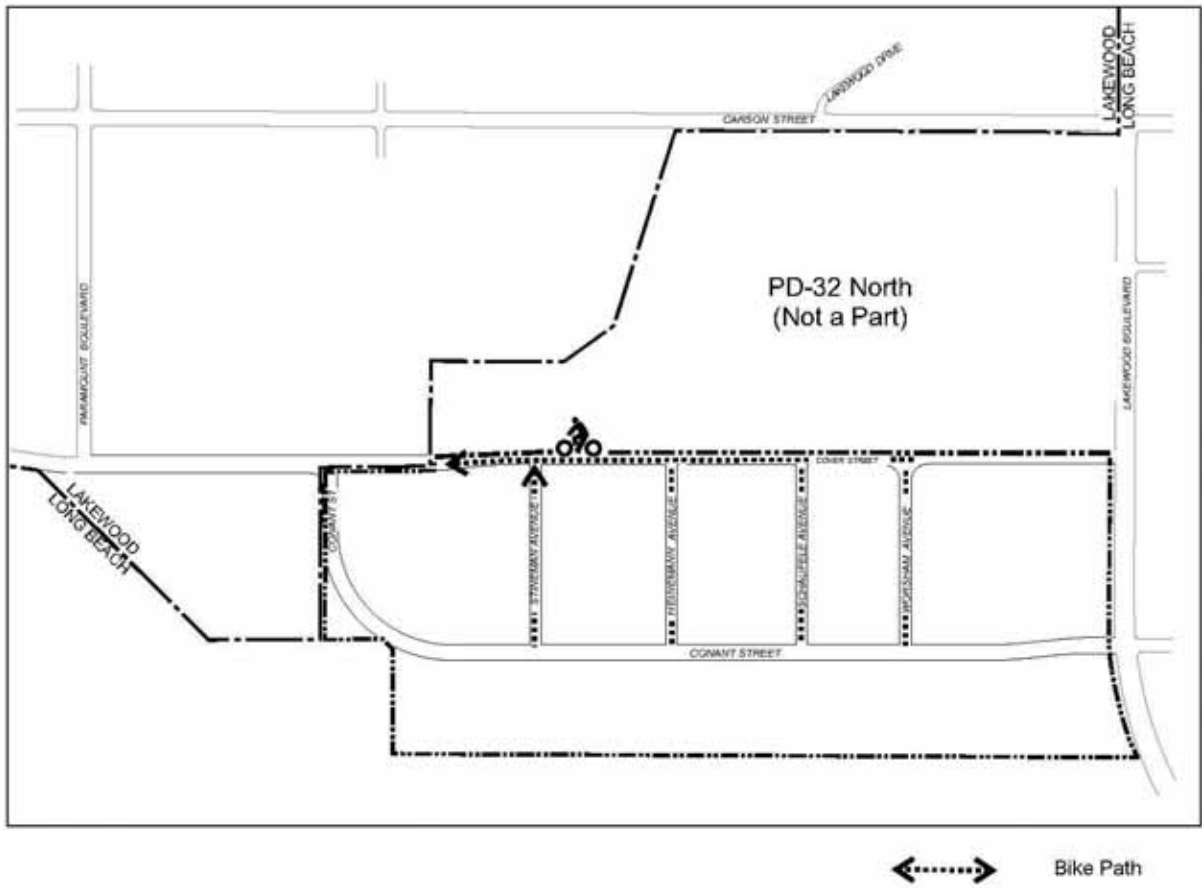

Figure 6 : Bike Paths

Build-To Lines

Build-to-lines are defined as a continuous building edge at the property lines on designated streets, allowing for occasional breaks in the street wall for features such as entries, courtyards, or mid-block Paseos. They are established in selected locations to create a consistent street edge that defines the street as a pedestrian friendly cohesive space.

Certain streets have mandatory setbacks from the property line and are identified in the section on Setbacks in this document; build-to lines shall be observed at the boundary of such setback. See Special Development Standards (Division 3) in this document for specific requirements and criteria for each sub area.

View Corridors

View corridors follow street alignments and are established to preserve orientation, provide a sense of place through visual linkages to the existing golf course and the Airport. No building or portion thereof shall block a view corridor.

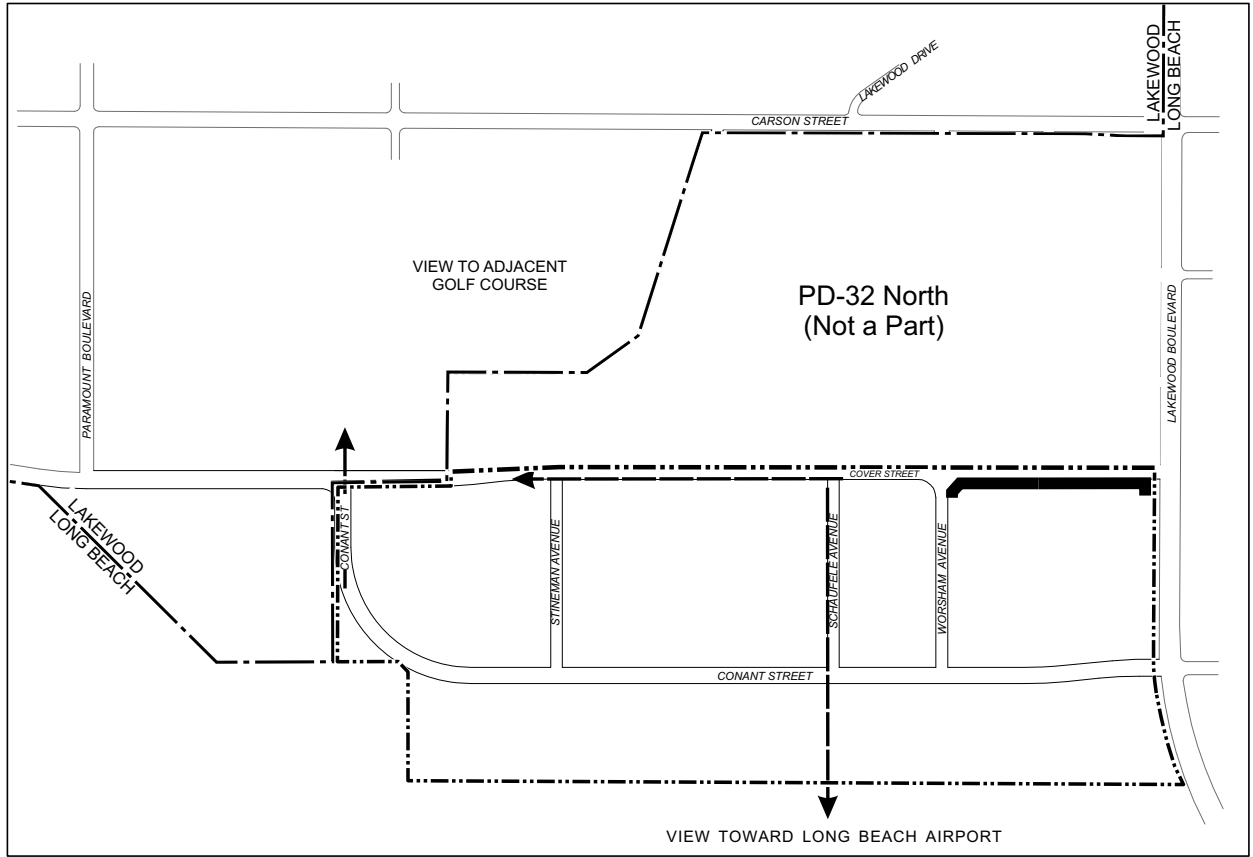

- 

View Corridors
(Alignments shown on map are general in nature)
- 

Primary 'Build-To' Lines
(See special development standards for Sub Area 7 for additional information)

Figure 7 : Build-To Lines & View Corridors

Generalized Height Zones

PD-32; South has two types of height restrictions, and the most restrictive provision shall apply in every instance.

Federal Aviation Administration (FAA)

All building heights shall conform to the Long Beach Airport – Runway Approach Zones – Standard for determining obstruction in air navigation – as per Part 77 of federal aviation regulations map dated 6-21-1982 (or as updated). The maximum heights depicted on such map are measured by mean sea level and must be measured to the highest portion of the structure, including antennas, signs, elevators, mechanical equipment and other appurtenances. The applicant is responsible for thoroughly investigating all restrictions for an individual parcel of land on the site, including the filing and processing of any required forms with the FAA (see Figure 8).

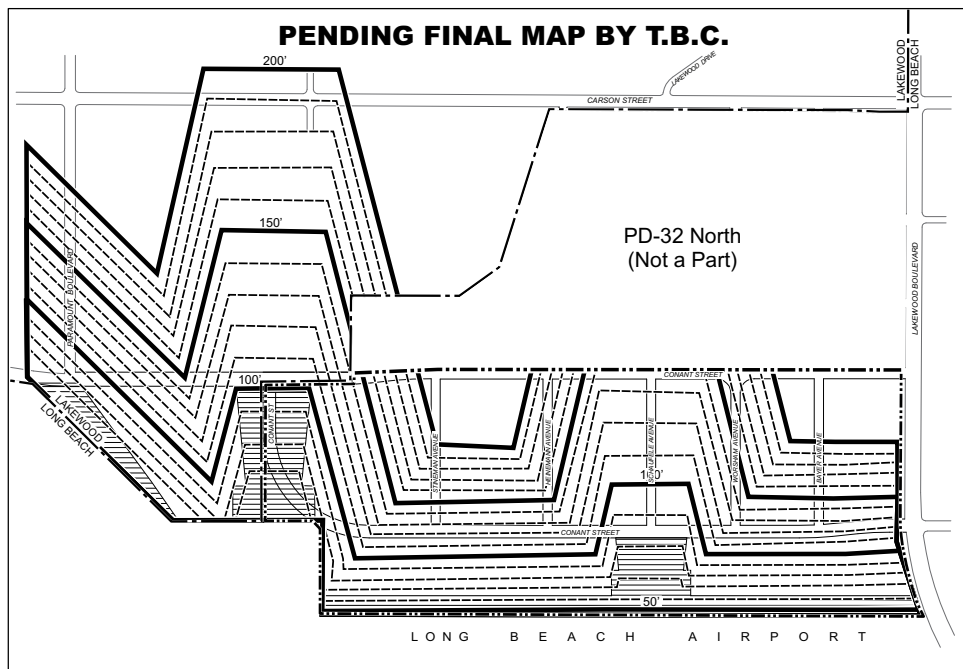

For Reference Only :Based on the City of Long Beach Airport Runway Approach Zones Standards for determining obstructions to Air Navigation. As per Part 77 of the FAA Regulations Map dated 6-21-1982 (or as updated).

- Building Restriction Zone
(Parking may be permitted subject to City approval)
- FAA Contours

Figure 8 : FAA Height Contours

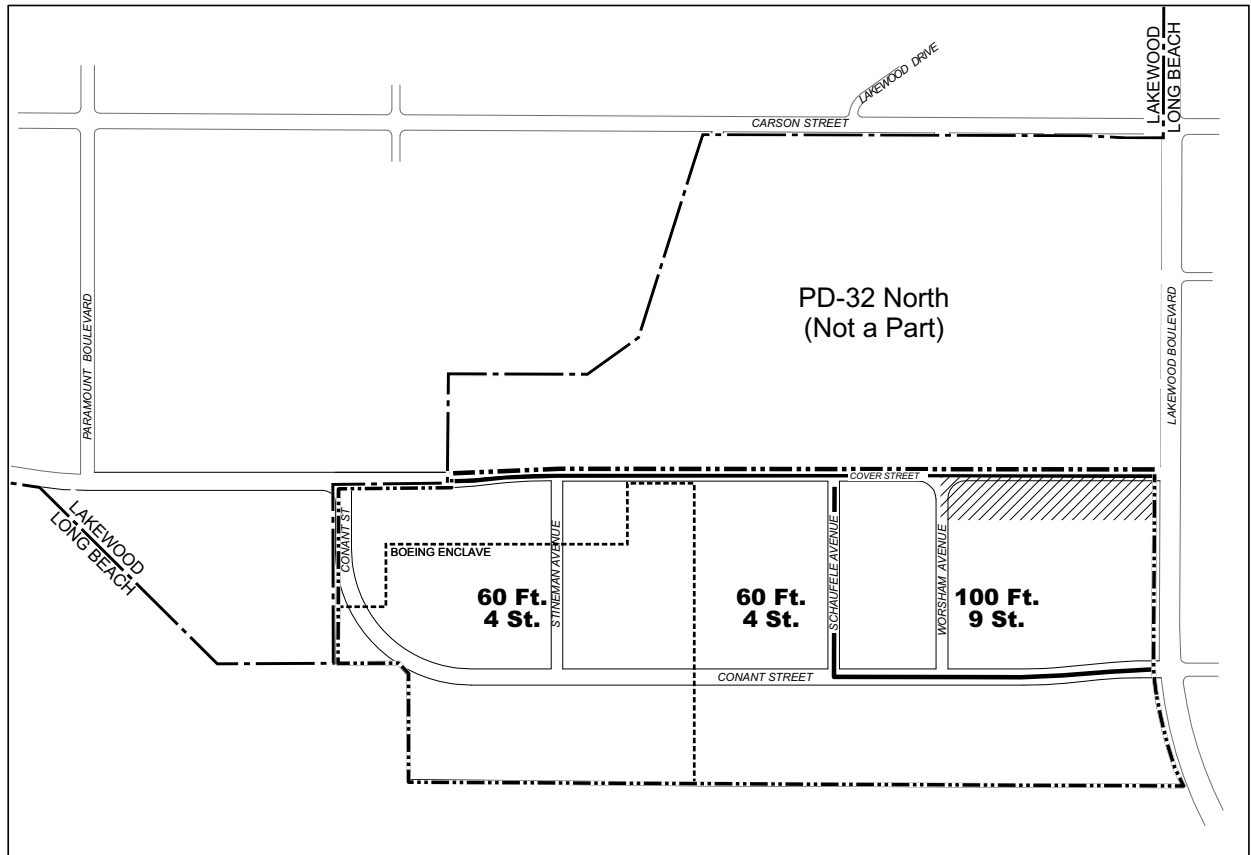

Story (St.) : As defined in LBMC Chapter 21.15.2940

NOTE : The maximum height limits indicated on this map are further detailed in the special development standards. These heights shall be used in conjunction with Part 77 of the FAA Regulations Map dated 6-21-1982 (or as updated).



Mixed-Use Overlay Zone
(See special development standards for sub area 7)

Figure 9 : Generalized Height Zones

PD-32 Height Zones

All building heights shall be consistent with the definition of height contained in LBMC Section 21.15.1330, and shall be measured from the curb to the top of the parapet or mid-point of a sloping roof of the proposed structures. Unoccupied architectural features may exceed these limitations through the Site Plan Review process, provided such features are consistent with the Urban Design intent of marking project entries, establishing street wall edges, and/or creating visual markers.

Figure 9 establishes the maximum permitted building heights in both feet and stories. A measurement of height shall use the definition of height contained in LBMC Section 21.15.1330.

Exceptions

- Exceptions listed in LBMC Section 21.31.220 shall apply.

Stepbacks

Building stepbacks are in addition to building setbacks, and are established to create height and bulk transitions between buildings and public streets, as well as between higher density uses and lower density uses. These transitions shall be controlled by building setback/ stepback requirements as shown in the illustrative sections included in Divisions II and III of this document.

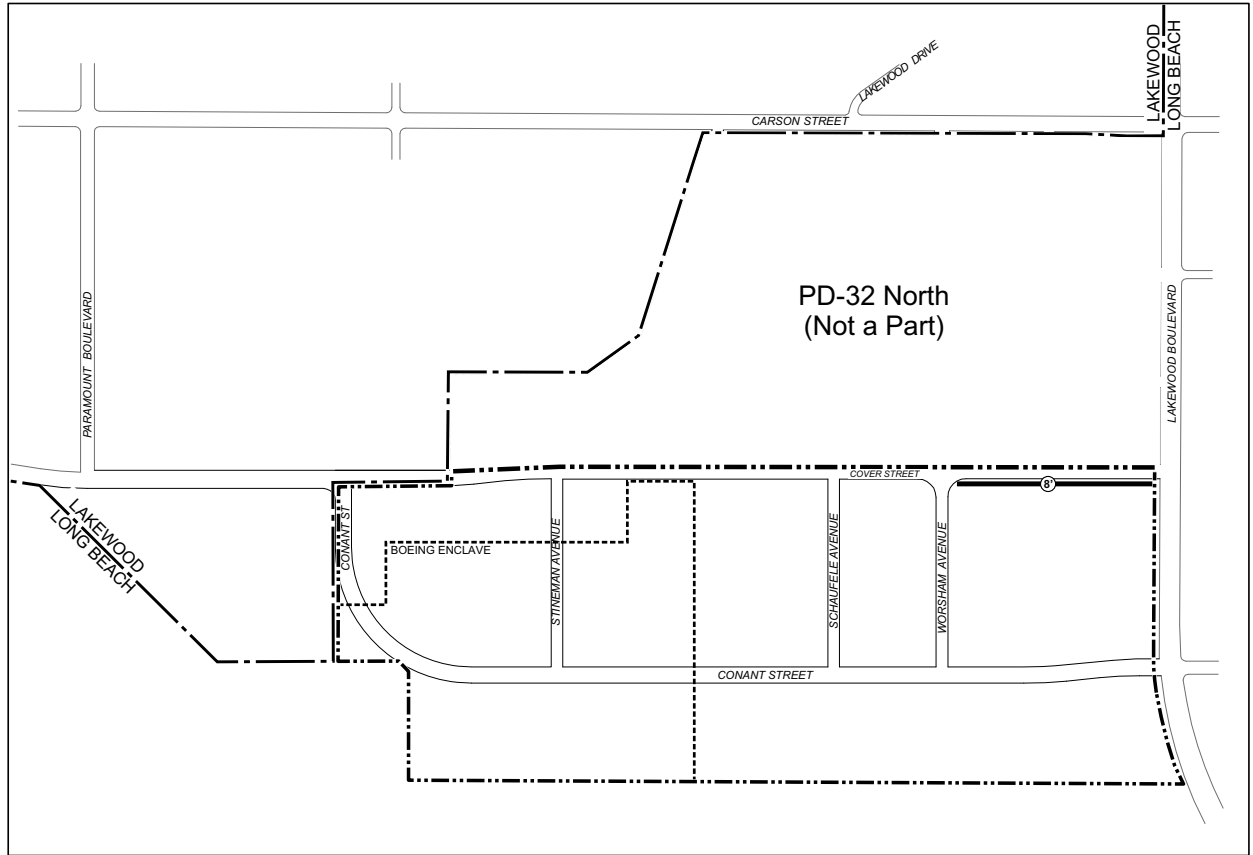

— 8' — 8-foot step-back along Cover Street
 (See special development standards
 for sub area 7)

Figure 10 : Step-Backs Diagram

S t a n d a r d s - D i v i s i o n I I I
C o m m e r c i a l / I n d u s t r i a l S u b A r e a S t a n d a r d s

C o m m e r c i a l / I n d u s t r i a l S u b A r e a S t a n d a r d s

Unless otherwise noted in this document, all development in the commercial and industrial sub areas is intended to be consistent with the commercial/ industrial districts development standards in the LBMC.

Permitted Uses

The principal use in all commercial sub areas shall be commercial and /or industrial as indicated in Table 2. Residential use is not permitted.

Table 2 indicates the classes of uses permitted (Y), not permitted (N), permitted as a conditional use (C), permitted as an administrative use (AP), permitted as an accessory use (A), and permitted as a temporary use (T) in all districts. Some classes of uses may be classified as "Y/C". "Y/C" shall mean a use is permitted by right unless located on a lot within three-hundred (300') or less from the nearest residential district, in which case a Conditional Use Permit (C) shall be required pursuant to Chapter 21.25, Division II of the LBMC. The location of the lot housing a proposed use relative to a residentially-zoned property shall represent the sole factor for determining whether discretionary review is required. If any building housing the principal proposed use in Sub Area 8A or 8B, or any outdoor activity which represents the principal use of the property, is located on a lot three hundred (300') or less from the nearest residential district, then Conditional Use Permit (C) review shall be required.

Primary uses shall have a minimum employment density (jobs factor) of at least 10 jobs per acre.

In recognition of the fact that industrial and manufacturing technologies change over time, the City has structured these regulations to address the operating characteristics and processes of industrial uses, rather than specific businesses. Thus, the determination of whether a use is permitted by right or requires discretionary review will necessarily require interpretation. For uses or activities not specifically identified in Table 2, the Zoning Administrator shall have the authority to interpret and assign the appropriate SIC code for that use or activity, with certain determinations being made via the Zoning Confirmation Letter Process (with fee included). The Zoning Administrator shall have the authority to determine if a Zoning Confirmation Letter is required to make certain determinations. The decision of the Zoning Administrator can be appealed to the Planning Commission pursuant to Chapter 21.21, Division V (Appeals) of the Zoning Ordinance.

Commercial uses in Mixed Use Overlay Zone

Sites fronting on the southerly edge of Cover Street between Lakewood Boulevard and Worsham Avenue shall permit the commercial uses of the Neighborhood Commercial, Pedestrian oriented (CNP) zoning district of Chapter 21.32 of the LBMC.

Definitions

Floor Area

Floor Area means the total area of all floors of a building, as measured to the exterior surfaces of exterior walls. Floor Area includes halls and lobbies of a building, but does not include utility and elevator cores, stairwells, parking and restrooms.

Accessory Use

Accessory Use means a use that is customarily incidental and/or necessarily related to the principal use of the land, building, or structure. An accessory use is located on the same lot as the principal building or use and is dependent upon the principal use for the majority of its use or activity.

Warehouse

Warehouse means a building or portion thereof where goods or materials that are ready to be delivered to a retail outlet or sold to another business are kept for a period of time greater than seventy-two (72) hours prior to such delivery or sale.

Distribution

Distribution means a building or portion thereof where goods or materials that are ready to be delivered to a retail outlet or sold to another business are kept for a period of time less than seventy-two (72) hours prior to such delivery or sale.

Fulfillment Center

Fulfillment center is a use that can include warehousing and distribution components, but also includes order processing, returns, packaging, marketing, and other uses associated with orders shipped directly to customers or businesses. Typically, fulfillment centers include a larger office component than a traditional warehousing or distribution use, and generally utilize smaller delivery vehicles (delivery vans, box trucks, and the like).

Table 2 : Uses in Commercial / Industrial Sub Areas

Use	7 Zone	8A Zone	8B Zone*	Notes
Alcoholic Beverage Sales				The concentration of existing ABC licenses and the area crime rate are factors considered in reviewing applications for alcohol sales
Off-premises sales w/in 500 ft. of district allowing residential uses	C	N	N	For alcoholic beverage sales exempted from the CUP process, see footnote (1).
Off-premises sales more than 500 ft. from district allowing residential uses	Y	N	N	
On-premises sales w/in 500 ft. of district allowing residential uses	C	C	N	
On-premises sales more than 500 ft. from district allowing residential uses	Y	Y	N	
Automobile (Vehicle) Uses				All outdoor display, storage, service and repair of vehicles is subject to special standards (see LBMC Chapter 21.45)
Auto detailing (with hand held machines only)	AP	AP	N	Mobile businesses prohibited. Permitted in 8A Zoning District: Auto Detailing (with hand held machines only) only as accessory use to parking structure
Car wash	N	N	N	
Diesel fuel sales	N	N	N	See LBMC Section 21.52.222.
Gasoline sales	N	N	N	
General auto repair (body work, painting, etc.)	N	C	N	Uses allowed indoors only.
Limousine service (does not include auto repair)	AP	AP	N	Nonconforming parking rights do not apply (see LBMC Section 21.27.070).
Minor auto repair, tune up, and lube, smog test	N	N	N	
Motorcycle/jet ski sales and repair	C	C	N	Also see industrial zones, Table 33-1
Parking service – principal use	C	C	N	Interim Use Only. No permanent Parking Services shall be permitted
Recreational vehicle storage	C	C	N	Interim Use Only. No permanent Recreational vehicle storage shall be permitted
Rental agency (does not include repair)	Y	Y	N	
Automobile Sales (does not include auto repair)	N	N	N	
Towing	N	A	N	Accessory to general auto repair. Free-standing tow yards shall be prohibited.
Vehicle parts (with installation); tire store	C	N	N	
Vehicle parts (w/o installation)	Y	N	N	

Table 2 (continued) : Uses in Commercial / Industrial Sub Areas

Use	7 Zone	8A Zone	8B Zone*	Notes
Billboards	N	N	N	All Billboards Prohibited
Business Office Support				
Copy, fax, mail box, or supplies	Y	Y	N	
Equipment sales, rental, or repair	Y	Y	N	
Off-set printing	Y	Y	N	
Entertainment				
Amusement machines (4 or fewer)	A	A	N	See Zoning Code Section 21.51.205 (special development standards).
Banquet room rental	A	A	N	Accessory to restaurant only (see LBMC Section 21.51.215).
Dancing (accessory use)	Y	Y	N	Accessory to restaurant, tavern, club. City Council hearing is required for new and transferred business licenses.
Live or movie theater (w/100 seats or less)	Y	N	N	For theaters w/more than 100 seats, see "Movie theater."
Mock boxing or wrestling	N	N	N	
Movie theater (or live theater w/100+ seats)	C	N	N	
Pool tables (up to 3 tables)	A	A	N	Accessory to restaurant, tavern, club (see LBMC Section 21.51.260).
Private club, social club, night club, pool hall or hall rental within 500 ft. of district allowing residential uses	C	N	N	City Council hearing is required for new and transferred business licenses.
Restaurant with entertainment	Y	A	N	City Council hearing is required for new and transferred business licenses. Restaurants proposing to locate within 8A shall be allowed only as an accessory use on the ground floor of Office building.
Other entertainment uses (arcade, bowling alley, miniature golf, tennis club, skating rink, etc.)	C	C	N	
Financial Services				
ATM – Walk-up or freestanding machine on interior of building; walk-up machine on exterior of building	Y	Y	N	Requires 2 (5 minute) parking spaces for each ATM machine. Spaces shall be located within 100 ft. Such spaces may be existing required parking.
ATM – Freestanding machine, exterior	AP	AP	N	
ATM – Drive-thru machine	AP	AP	N	For drive-thru machine see standards for drive-thru lane in LBMC Section 21.45.130.
Bank, credit union, savings & loan	Y	Y	N	
Check cashing	N	N	N	
Escrow, stocks and bonds broker	Y	Y	N	
All other financial services not listed above	C	C	N	
Food Processing				

Table 2 (continued) : Uses in Commercial / Industrial Sub Areas

Use	7 Zone	8A Zone	8B Zone*	Notes
Food and kindred products (SIC Code 20)	N	Y/C	N	Permitted in 8A Zoning District: All uses included in SIC Code 20, except as noted below. SIC Code 2048 (includes slaughtering animals for animal feed) SIC Code 201 (includes meat packing plants, meat & poultry products) SIC Code 2091 (Canned & Cured Fish and Seafood) SIC Code 2092 (Prepared Fresh or Frozen Fish/ Seafoods) Any Permitted use proposing to locate within 300 feet of a Residentially Zoned property shall be subject to a Conditional Use Permit, subject to the requirements in LBMC Sections 21.25.201 thru 21.25.212.
Institutional				
Church or temple	N	N	N	
Convalescent hospital or home	N	N	N	
Crematorium	N	N	N	
Day care or preschool	C	N	N	
Industrial arts trade school	Y	Y	N	
Mortuary	N	N	N	
Parsonage	N	N	N	
Private elementary or secondary school	N	N	N	
Professional school/business school	Y	Y	N	
Social service office (with food distribution)	N	N	N	
Social service office (without food distribution)	N	N	N	
Other institutional uses	C	C	N	
Manufacturing				Permitted in 8A Zoning District: The uses within these SIC Codes are limited to operations containing primarily manufacturing space with accessory display and storage uses.
Apparel and other finished products made from fabrics and similar materials (SIC Code 23)	N	Y	N	
Printing, publishing and allied industries (SIC Code 27)	N	Y	N	
Chemicals & Allied Products Mfgs (SIC Code 28)	N	N	N	
Leather and leather products (SIC Code 31)	N	Y	N	Prohibited in 8A Zoning District: SIC Code 311 (Leather Tanning and Finishing)
Electronic and other electrical equipment and components, except computer equipment (SIC Code 36)	N	Y	N	

Table 2 (continued) : Uses in Commercial / Industrial Sub Areas

Use	7 Zone	8A Zone	8B Zone*	Notes
Measuring, analyzing, and controlling instruments; photographic, medical and optical goods; watches and clocks (SIC Code 38)	Y	Y	N	
Miscellaneous manufacturing industries (SIC Code 39) - Including Jewelry Manufacturing; Toys Manufacturing; Sporting Goods Manufacturing; and Household Products.	N	Y	N	Permitted in 8A Zoning District: All uses included in SIC Code 39, so long as the specific operation of the use is non-nuisance in nature (e.g., noise, hazardous materials, odors, dust, light and glare) and are either confined completely within the property or result in limited secondary impacts in terms of traffic, air emissions, and hours of operation, consistent with LBMC Section 21.33.020.
Furniture and Fixtures (SIC Code 25)	N	Y	N	
Paper and allied products (SIC Code 26)	N	Y	N	Prohibited in 8A Zoning District: SIC Code 261 (Pulp Mills) SIC Code 262 (Paper Mills) SIC Code 263 (Paperboard Mills)
Rubber and miscellaneous plastics products (SIC Code 30)	N	Y/C	N	Prohibited in 8A Zoning District: SIC Code 3011 (Tires & Inner Tubes)
Textile mill products (SIC Code 22)	N	Y/C	N	
Lumber and wood products, except furniture (SIC Code 24) - Including: Hardwood Products; Wooden Cabinets Miscellaneous Wood Products	N	Y/C	N	Prohibited in 8A Zoning District: SIC Code 2411 (Logging) SIC Code 2421 (Sawmills & Planning Mills - General) Permitted in 8A Zoning District: All other uses included in SIC Code 24, so long as the specific operation of the use is non-nuisance in nature (e.g., noise, hazardous materials, odors, dust, light and glare) and are either confined completely within the property or result in limited secondary impacts in terms of traffic, air emissions, and hours of operation, consistent with Zoning Code Section 21.33.020.
Stone, clay, glass, and concrete products (SIC Code 32)	N	Y/C	N	Prohibited in 8A Zoning District: SIC Code 324 (Hydraulic Cement) SIC Code 325 (Structural Clay Products) SIC Code 327 (Concrete, Gypsum, and Plaster Products)
Fabricated metal products, except machinery and transportation equipment (SIC Code 34)	N	Y/C	N	Prohibited in 8A Zoning District: SIC Code 348 (Ordinance and Accessories)
Industrial and commercial machinery and computer equipment (SIC Code 35)	N	Y	N	
Transportation equipment (SIC Code 37)	Y	Y	Y	
Tobacco products (SIC Code 21)	N	Y/C	N	

Table 2 (continued) : Uses in Commercial / Industrial Sub Areas

Use	7 Zone	8A Zone	8B Zone*	Notes
Petroleum refining and related industries (SIC Code 29)	N	N	N	
Primary metal industries (SIC Code 33)	N	N	N	
Electric Gas & Sanitary Services (SIC Code 49)	N	N	N	
Personal Services				
Basic personal services (barber/beauty shop, catering, party counseling (w/o trucks), diet center, dog/cat grooming, dry cleaner, fitness center/health club, dance/karate studio, locksmith, mailbox rental, nail/manicure shop, repair shop for small appliances or electronic equipment, bicycles, tailoring, shoe repair, tanning salon, travel agent, or veterinary clinic w/o boarding).	Y	A	N	Basic personal service uses proposing to locate within 8A shall be allowed only as an accessory use on the ground floor of Office building.
House cleaning service	AP	AP	N	
Laundromat	C	N	N	
Laundry, cleaning and garment services (SIC Code 721)	N	Y	N	
Massage therapy	A	A	N	See special conditions in LBMC Section 21.51.243. Special adult entertainment standards for massage parlor (see LBMC Section 21.45.110).
Recycling center	N	N	N	
Recycling collection center for cans and bottles (staff attended)	N	N	N	
Recycling containers for cans and bottles	A	N	N	Accessory to a grocery store only (see LBMC Section 21.51.265).
Repair shop (stove, refrigerator, upholstery, lawn mowers, etc.) - (SIC Code 76)	N	Y	N	For small appliance repair, see "Basic Personal Services."
Repair services with outdoor operations (SIC Code 76)	N	N	N	
Self-storage (indoor only)	N	N	N	
Shoe-shine stand (indoor/outdoor)	A	A	N	Accessory to barber, car wash, grocery, hotel, office, or restaurant use.
Tattoo parlor	N	N	N	
Termite and pest control	N	C	N	See "Misc. – Storage of Hazardous Materials."
Veterinary Services for Animal Specialties (SIC Code 0742) Animal Specialty Services, Boarding, Kennels, Shelters (SIC Code 0752)	N	C	N	Also see "Basic Personal Services."
All personal services not listed	AP	AP	N	
Professional Services				

Table 2 (continued) : Uses in Commercial / Industrial Sub Areas

Use	7 Zone	8A Zone	8B Zone*	Notes
Accounting, advertising, architecture, artist studio, bookkeeping, business headquarters, chiropractic, computer programming, consulting, contracting, dentistry, engineering, insurance, law, marketing, medicine, photography, psychiatry, psychology, real estate, or tax preparation (Including SIC Codes 60, 61, 62, 63, 64, 65, 67, 73 [except 7353 and 7359], 861, 862, 863, 864, and 87)	Y	Y	N	Prohibited in 8A Zoning District: SIC Code 9223 (Correctional Institutions) SIC Code 8744 (Jails, privately operated- correctional facilities, adult privately operated) SIC Code 7353 (Heavy Construction Equipment Rental) SIC Code 7359 (Equipment Rental and Leasing) Permitted in 7 & 8A Zoning Districts: The uses within these SIC Codes are limited to operations containing primarily office space with accessory display and storage uses.
All professional offices not listed	AP	AP	N	
Aviation-Related Uses				
Aviation-related uses including, maintenance and storage, pilot/ passenger amenities (restrooms, food services, classrooms and office spaces), charter operations and aircraft rentals (SIC Code 45)	C	C	N	All aviation-related uses must meet the provisions of the City's Noise Compatibility Ordinance, the Airport Rules, Regulations and Minimum Standards for aeronautical activities and be subject to Long Beach Airport fees for like aeronautical activities as specified in the Airport Rates & Fees Resolution.
Aircraft Storage	Y	Y	Y	SIC Code 45 uses shall require a conditional use permit outside the boundaries of the Long Beach Airport and/or on adjacent properties directly supporting airport operations. Further, certain uses may be subject to "Through-the-Fence" agreement(s) between the City of Long Beach and Long Beach Airport. Aviation-related uses shall be allowed only in the geographic area south of "G" Street.
Aircraft Services for On-site Aircraft (For on-site aircraft only (not for commercial purposes))	Y	Y	Y	
Commercial Aviation Services (Provided by those holding valid agreements to conduct business on Long Beach Airport)	Y	Y	Y	
Special Events	Y	Y	Y	Special Events including aeronautical uses not covered above, as approved in advance by the Airport Manager.
Residential Uses	N	N	N	No Residential Uses shall be permitted.
Restaurant And Ready-To-Eat Foods				
Outdoor dining	A	A	N	
Restaurants and ready-to-eat foods with drive-thru lanes	N	N	N	Special standards apply (See LBMC Section 21.45.130).
Restaurants and ready-to-eat foods without drive-thru lanes	Y	A	N	Restaurants proposing to locate within either 8A or 8B shall be allowed only as an accessory use on the ground floor of Office building.
Vending carts	AP	AP	N	Special standards apply (See LBMC Section 21.45.170).
Retail Sales				

Table 2 (continued) : Uses in Commercial / Industrial Sub Areas

Use	7 Zone	8A Zone	8B Zone*	Notes
Basic retail sales (SIC Codes 54, 5735, 5942, 7841) (except uses listed below)	Y	A	N	Used clothing, antiques, art, books (new and used), coins, collectibles, food stores, jewelry, and trading cards are included in "Basic Retail Sales." Basic retail sales uses proposing to locate within 8A shall be allowed only as an accessory use on the ground floor of an Office building.
Building supply or hardware store with lumber, drywall, or masonry (including SIC Code 52, 57)	Y	N	N	For hardware store without lumber, drywall, or masonry, see "Basic Retail Sales."
Gun Store and Gun Repair	AP	N	N	Allowed only as an accessory use to primary Sporting Goods establishment
Major household appliances (refrigerator, stove, etc.)	Y	Y	N	
Manufacture of products sold on-site	A	A	N	See LBMC Section 21.51.240.
Merchandise mall, indoor swap meet	N	N	N	
Outdoor sales events (flea markets, swap meets, etc.)	N	N	N	
Outdoor vending – Flower, plant, fruit, or vegetables in conjunction with sale of related products from a retail store	A	N	N	See LBMC Section 21.51.255.
Outdoor vending – Food carts	AP	AP	N	See LBMC Section 21.45.170.
Outdoor vending – Flower cart or news cart	Y	Y	N	See LBMC Section 21.45.135.
Pawn shop	N	N	N	
Thrift store, used merchandise	N	N	N	Also see note under "Basic Retail Sales."
Vending machines	A	A	N	Accessory to existing retail sales. See LBMC Section 21.51.295.
Temporary Lodging				
Hotel/Motel	Y	Y	N	
Shelters	N	N	N	
Temporary Uses				
Carnival, event, fair, trade show, etc.	T	T	N	
Construction trailer	T	T	T	
Outdoor Vending – Mobile food truck at construction sites	T	T	T	See LBMC Section 21.53.106.
Transportation & Communication Facilities				
Communications Facilities – Freestanding monopole cellular and personal communication services	C	C	N	See LBMC Section 21.52.210.
Communication Facilities – Attached/ roof mounted cellular and personal communication services	Y	Y	N	See LBMC Section 21.45.115.
Communications (SIC 48)	N	Y/C	N	SIC Code 483 (Radio and television broadcasting stations) and Microwave transmission or relay towers are permitted only with approval of a Conditional Use Permit
Communication Facilities – Electrical distribution station	C	C	N	

Table 2 (continued) : Uses in Commercial / Industrial Sub Areas

Use	7 Zone	8A Zone	8B Zone*	Notes
Local and suburban transit and interurban highway passenger transportation (SIC Code 41)	N	N	N	
Local Trucking Without Storage (SIC Code 4212)	N	N	N	
Courier Service Except by Air (SIC Code 4215)	N	C	N	Includes parcel delivery companies such as Fed-Ex, UPS, and similar uses
Transportation Services (SIC Code 47) - Including: Tour Operators; Transportation Consulting;	N	C	N	
Transportation-Related Uses with no outdoor container storage	N	N	N	
Transportation-Related Uses with outdoor container storage associated with shipping/ trucking/rail	N	N	N	
Helipads	C	C	N	Aviation-related uses shall be allowed only in the geographic area south of "G" Street.
Wholesale Trade				
Wholesale Trade - durable goods (SIC Code 50) - and nondurable goods (SIC Code 51)	Y	Y	N	Permitted in 7 & 8A Zoning Districts: Fulfillment centers are considered Wholesale Trade uses for the purposes of this title. Third party logistics facilities classified as SIC Code 4212.
Miscellaneous				
Office, research and development, aircraft manufacturing and aircraft manufacturing related uses.	N	N	Y	

* 8B Zone is that area known as the "Boeing Enclave" -- Once Boeing declares its intention to abandon any aviation-related uses within either all or a portion of the 8B area, the Zoning shall immediately revert to the 8A Zoning standards then in effect. Should a portion of the land Zoned 8B revert to 8A Zoning, only that portion of land shall be affected by the reversion, NOT the entire land area Zoned 8B.

Abbreviations:

Y = Yes (permitted use).

N = Not permitted (prohibited use).

Table 2 (continued) : Uses in Commercial / Industrial Sub Areas

C = Conditional Use Permit required. For special conditions, see LBMC Chapter 21.52

A = Accessory Use. For special development standards, see LBMC Chapter 21.51

AP = Administrative Use Permit required. For special conditions, see LBMC Chapter 21.52

T = Temporary Use. Subject to provisions contained in LBMC Chapter 21.53

Y/C = Either permitted by right or subject to Conditional Use Permit review, depending upon locational criteria contained under "Permitted Uses".

Footnote:

(1) The following alcoholic beverage sales may be exempted from the Conditional Use Permit requirement.

a. Restaurants with alcoholic beverage service only with meals. This generally means any use with a fixed bar is not exempt. A service bar is not considered a fixed bar. A sushi bar, where alcoholic beverages are served at the same bar where meals are served, is considered serving alcoholic beverages only with meal service. A cocktail lounge without a bar, but with primarily service of only hors d'oeuvres and alcoholic beverages is not exempt. Any restaurant with more than 30 percent of gross sales consisting of alcoholic beverages shall lose its exemption and be required to obtain a Conditional Use Permit to continue to sell alcohol.

b. Use located more than 500 ft. from zoning districts allowing residential use.

c. Department store or florist with accessory sale of alcoholic beverages.

d. Grocery stores of 20,000 sq. ft. or greater with accessory sale of alcoholic beverages.

e. Existing legal, nonconforming uses. (Ord. C-7663 § 42, 1999).

Minimum Lot Area

Table 3 establishes the minimum lot area in each sub area.

Table 3 : Permitted Lot Area in Commercial Sub Areas

Sub Area	Minimum Lot Area
Sub Area 7	20,000 sq.ft.
Sub Area 8A	15,000 sq.ft.
Sub Area 8B	<i>This sub area will allow current aviation-related uses to continue. Should current uses within this sub area be discontinued, the area will be developed with uses consistent with sub area 8A</i>

Setbacks

Setbacks shall be provided for the purpose of providing light, air, pedestrian and vehicular circulation, emergency access and general aesthetic improvements.

The required setbacks indicated in Table 4 shall be clear of all structures from the ground to the sky (except as otherwise permitted) and shall be landscaped and maintained in a neat and healthy condition according to the landscaping provisions of this document. Where setbacks are required, 25% of the frontage is allowed without a setback.

Table 4 : Required Yard Setbacks between Buildings and Property Lines in Commercial Sub Areas

Sub Area	Minimum Front Yard Setbacks for Building (ft.)		Minimum Setback from Interior Property Line (ft.)
	From Arterial Road	From Local Street	
Sub Area 7	18 ft. *	18 ft.	5 ft. **
Sub Area 8A	18 ft.	18 ft.	5 ft. **
Sub Area 8B	<i>This sub area will allow current aviation-related uses to continue. Should current uses within this sub area be discontinued, the area will be developed with uses consistent with sub area 8A</i>		

* Refer to Special Development Standards for additional setback requirements for the mixed-use overlay zone.

** Subject to Siteplan Review Process

Table 5 : Required Yard Setbacks between Parking Lots and Property Lines in Commercial Sub Areas

Sub Area	Minimum Front Yard Setbacks for Parking Lot (ft.)		Minimum Setback from Interior Property Line (ft.)
	From Arterial Road	From Local Street	
Sub Area 7	6 ft. *	6 ft.	6 ft. **
Sub Area 8A	6 ft. *	6 ft.	6 ft. **
Sub Area 8B	<i>This sub area will allow current aviation-related uses to continue. Should current uses within this sub area be discontinued, the area will be developed with uses consistent with sub area 8A</i>		

* Along Cover Street surface parking lots shall be setback 18 ft. from property line.

** This standard can be waived for property lines between joint-use parking lots through site plan review process

Corner Cut-off

At corners of properties at street intersections, intersections of streets and alleys and at intersections of driveways and property lines, new construction shall not be permitted in such a manner that it significantly impedes visibility between visibility between heights of 3 feet and 7 feet above the ground in a corner cut-off of at least 6 feet by 6 feet (Measured from the intersection of the property lines or the intersection of a driveway and a property line). One vertical support element such as a column is permitted in the corner area, if the cross-section of the element fits within a circle with a diameter of 18 inches. This requirement may be waived through the Site Plan Review process if the Director of Public Works finds that the cut-off is not necessary.

Permitted Structures

No structures are permitted in required setbacks (yards), except:

- Signs, as specified in the chapter relating to on-premises signs (LBMC Chapter 21.44);
- Outdoor dining (subject to approval from Site Plan Review Committee);
- Vehicle parking (surface lots). Table 15 of this document establishes the minimum landscaped setback required between the parking lot and the street property line.
- Awnings as allowed by the Uniform Building Code.
- Projections are permitted into the required setbacks in accordance with those permitted in the Commercial Zoning Districts of the LBMC (see LBMC Section 21.32.220 C)

Required Landscaping

All required setbacks, shall contain an area not less than 6 feet in width planted with trees, shrubs and/or ground cover. Along Cover Street and Conant Street, the entire eighteen feet (18) of setback shall be landscaped. With the exception of access driveways, surface parking shall be prohibited within the required landscaped setbacks of Cover & Conant streets. See Special Development Standards for additional requirements.

General Screening Requirements

The following required screening shall apply in all commercial sub areas:

Open Storage

Open storage shall be prohibited. Merchandise is not permitted to be displayed outdoors, unless specifically granted through Site Plan Review.

On-Grade Parking Garages

Architectural treatment

Parking structures must be designed with the same care and attention as the buildings they serve. They should be compatible in architectural treatment and detail.

Screening

Ramps, cars, and sources of artificial lighting in parking structures should be minimally visible from public streets, public parks, and residential uses.

Surface Parking Lots

All surface parking lots including parking area screening and landscaping shall be designed in accordance with the development standards in LBMC Chapter 21.41.

Mechanical Equipment on Rooftops

In all commercial zones, rooftop mechanical equipment, except solar collectors and rain gutters, shall be screened on all sides by screening not less than the height of the equipment being screened. Such equipment shall also be screened from view from higher buildings in the zone to the satisfaction of the Site Plan Review Committee and Long Beach Development Services.

Secured

All rooftop mechanical equipment shall be secured from unauthorized entry to the satisfaction of Long Beach Development Services.

Materials

All rooftop mechanical equipment screening devices shall be of a material requiring a low degree of maintenance. Wood shall not be utilized. All screening devices shall be well integrated into the design of the building through such items as parapet walls continuous with the walls of the structure, architectural roof features, or equipment rooms. Louvered designs are acceptable if consistent with the building design style.

Substitutions

Well-planned, compact, architecturally integrated rooftop equipment may be substituted for screening with the approval of the Site Plan Review Committee and Long Beach Development Services.

General Requirements for the Design of Buildings

All commercial buildings shall comply with the following design criteria:

Architectural Themes

Architectural themes, modules and materials present on the main facade of the building shall be used on all other facades.

Change of Material

Each side of a building must contain a primary and an accent material, and the accent material(s) must cover not less than ten percent (10%) of the facade.

Building Finished Grade

All commercial buildings shall have the first habitable floor level not more than four feet (4') above grade within the front thirty feet (30') of the lot.

Accessory Structures***Use Restrictions***

The use of accessory buildings and structures shall conform to the requirements of LBMC Chapter 21.51 (Accessory Uses).

Locations Permitted

Accessory structures and buildings may be placed anywhere on a lot except within the required setbacks.

Trash Receptacles

Adequate trash receptacles shall be provided to accommodate all refuse generated on a site. All trash areas shall be screened from public view on all sides, and shall conform to the development standards contained in LBMC Chapter 21.45 (Special Development Standards).

Utility Meters Screening

All utility meters shall be fully screened from view from a public right-of-way.

Undergrounding of Utilities

All projects requiring site plan review shall underground all overhead utility service to the site. The utility company's design of the electric system, including locations and aesthetic treatment, shall be in accordance with the regulations of the Public Utilities Commission of the State of California.

Off-street Parking and Loading Requirements

Parking and loading areas shall be provided as required in LBMC Chapter 21.41 (Off-Street Parking and Loading Requirements).

Landscaping Requirements

Landscaping shall be provided as required by LBMC Chapter 21.42 (Landscaping Standards) unless otherwise noted.

Fences and Garden Walls

Fences and garden walls are not permitted within required front street setbacks unless granted through the Site Plan Review process. Otherwise, fences and garden walls are permitted accessory structures subject to the development standards contained in LBMC Chapter 21.43 (Fences and Garden Walls).

Signs

On-premises signs are permitted in all districts subject to the requirements of LBMC Chapter 21.44 (On-premise Signs).

Right-of-way Dedications and Improvements

Public rights-of-way shall be reserved, dedicated and improved as provided for in LBMC Chapter 21.47 (Dedication, Reservation and Improvement of Public Rights-of-Way).

Special Development Standards

Sub Area 7

This sub area located immediately west of Lakewood Boulevard shall be primarily an office commercial use zone along with R&D, some light industrial uses and aviation-related uses south of Conant Street. In addition, hotel use will be located adjacent to one of the following: Lakewood Boulevard, Cover Street or Conant Street.

Along Cover Street, this sub area is the southern edge of a major “gateway” to the project, and shall be part of the Mixed Use Overlay zone in conjunction with Sub Area 1. This overlay zone is envisioned as an active “main street” pedestrian edge with ground floor retail storefronts, pedestrian serving uses, hotel lobby/ public uses, and upper story commercial uses, along with special on-street parking provisions.

Mixed-Use Overlay Zone

Frontages along Cover Street shall provide pedestrian-oriented uses, which are defined to include the following:

- Restaurants & ready-to-eat foods
- Retail sales
- Personal service uses
- Lobbies of: hotels, office buildings, residential developments, movie/live theaters, or of any other entertainment uses
- Public plazas and outdoor dining areas.

Pedestrian-oriented uses shall occupy at least 60% of the ground floor building frontage on streets where active pedestrian uses are required. “Shadow” art galleries, historical displays, artist studios, back office uses or sales offices may be allowed as temporary transitional uses.

Minimum Depth of Ground Floor Space

Within the Mixed Use Overlay Zone, ground floor spaces shall have a minimum average depth of 50 feet. Exceptions to this requirement may be granted through Site Plan Review.

Display/Clear Window Requirement

Clear, non-reflective display windows/doors shall comprise at least 60% of the ground floor street facade of pedestrian-oriented uses. Such glass should be clear with an exterior daylight reflectance of not more than eight percent (8%). Ground floor wall sections without windows should be not more than 5 feet in width, and the maximum height of the bottom sill of required display windows shall not exceed 30 inches above the adjacent sidewalk.

First Floor Elevation

In order to promote easy pedestrian access, the first level of buildings which require ground floor pedestrian oriented uses shall have a floor elevation which approximates the elevation of the adjacent sidewalk.

Setback

Required setback along streets with pedestrian serving uses shall be hardscape and shall be considered an extension of the sidewalk. No landscape of such setback is allowed.

Awnings and Canopies

Store front awnings are required, unless waived through the Site Plan Review process. The minimum vertical clearance between the ground or street level and the bottom of the awning should be 10 feet. Awnings should be placed below the ground floor cornice (or below the sills of the second story windows if no cornice exists). Awnings should be divided into sections to reflect the major vertical divisions of the facade. The awning/canopy may encroach over the public sidewalk provided at least 4 feet of clearance is maintained from the street curb line. For awnings and canopies, the materials, shape, rigidity, reflectance, color, lighting, and signage, should relate to the architectural design of the building.

Entrances Facing the Street

Entrances to uses on ground and upper floors must open onto the public right-of-way. Entrance doors should be setback at least three feet from the property line in order to avoid encroachment on to right-of-way.

Exterior Design

Exterior elevations shall be designed with extensive articulation to create visual interest and enhance pedestrian activity along the site. Three dimensional elements such as cornices, pilasters and structural bays shall be used to break up the facade planes. Ground floor facades shall be distinguished from upper floors by cornices, changes of material and/or other architectural devices.

Build-to line standard

A primary build-to line is established for buildings fronting Cover Street. At least 60% of the ground floor building frontage at a minimum height of 16 feet shall be constructed along the established build-to-line. Arcades, colonnades, porches, and articulated courtyard walls built along such line can be used to satisfy this requirement.

If the remaining portion of the ground floor is setback, it shall not be more than 20 feet in length nor setback more than 10 feet from the build-to-line, in order to maintain the continuity of the intended street wall.

Facade Articulation

Along Cover Street, no continuous building wall shall extend more than 60 feet in width without a facade articulation element.

Blank walls are not allowed along Cover. Elsewhere, the maximum width of a blank wall without articulation or relief of at least 6 inches in depth shall be 25 feet. Facade articulation shall consist of elements such as expressed structural bays, pilasters, moldings, recessed wall panels, or display features to create visual interest.

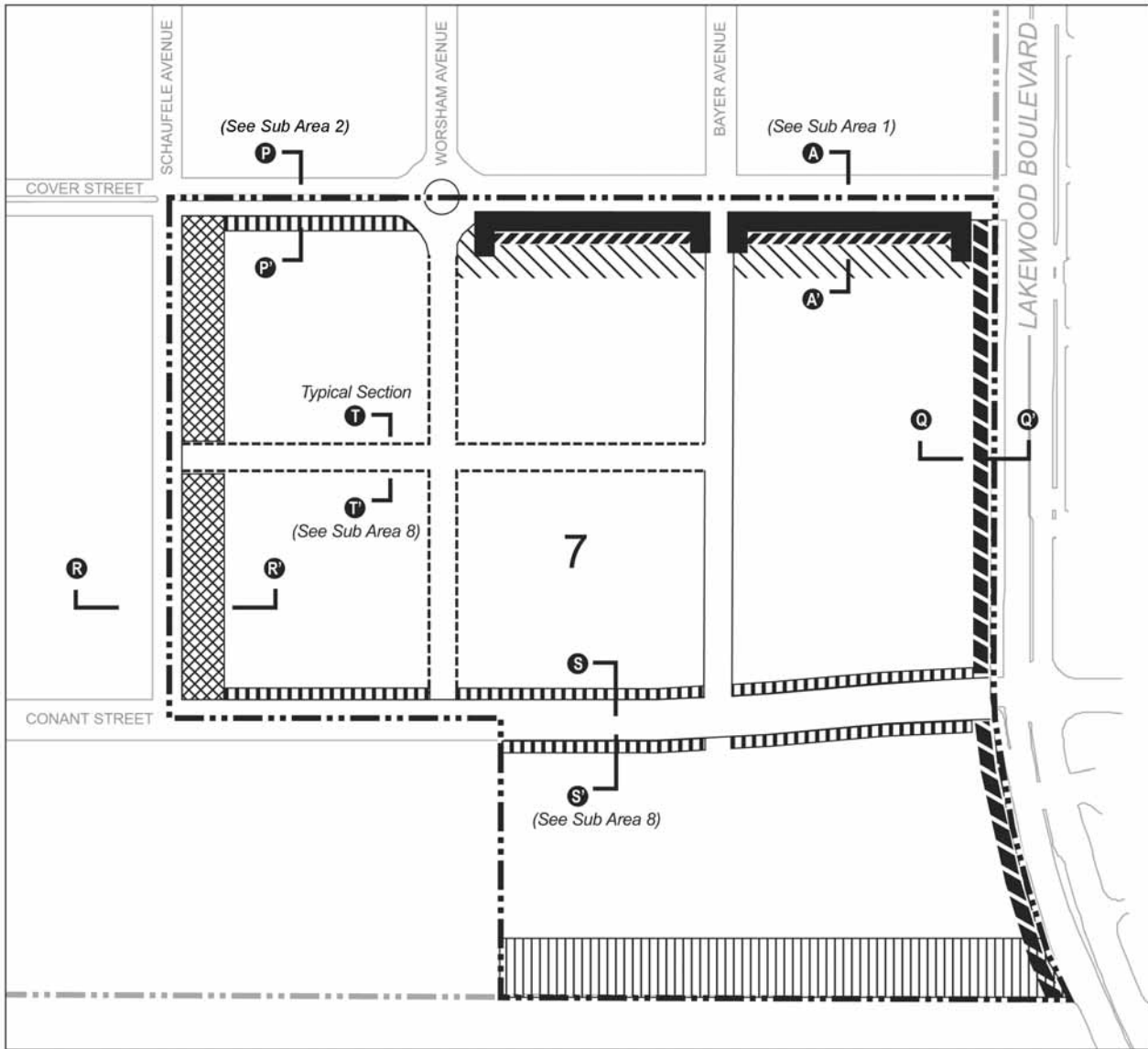









-  55' Minimum Building Setback along Schaufele Avenue
 -  Primary 'Build-To' Lines
 -  26' Minimum Building Setback along Lakewood Boulevard
 -  Preferred Location of Access Streets
 -  18' Minimum Building Setback along Cover and Conant Streets
 -  Mixed Use Overlay Zone
 -  Building Restriction Zone * (Parking may be permitted subject to City approval)
 -  8' Min. Building 'Step-Back' at 2nd. / 3rd. Story (Refer to Section A-A')
- * For Reference Only :Based on the City of Long Beach Airport Runway Approach Zones Standards for determining obstructions to Air Navigation. As per Part 77 of the FAA Regulations Map dated 6-21-1982 (or as updated).

Figure 11 : Sub Area 7

Building Stepbacks

Building stepbacks are in addition to building setbacks, and are established to create height and bulk transitions between buildings and public streets/ alleys/ parks, as well as between higher density uses and lower density uses. These transitions shall be controlled by building setback/ stepback requirements as shown in the illustrative sections included in this section of the document.

Vehicular Driveway Access

Vehicular driveway access is prohibited along frontages which require pedestrian-oriented uses. All other vehicular access shall be taken via secondary/ local streets that will not disrupt pedestrian circulation. Future access streets and driveways are encouraged to reinforce the grid imposed by the street hierarchy of the Plan Area. This requirement may be modified through the Site Plan Review process if necessary.

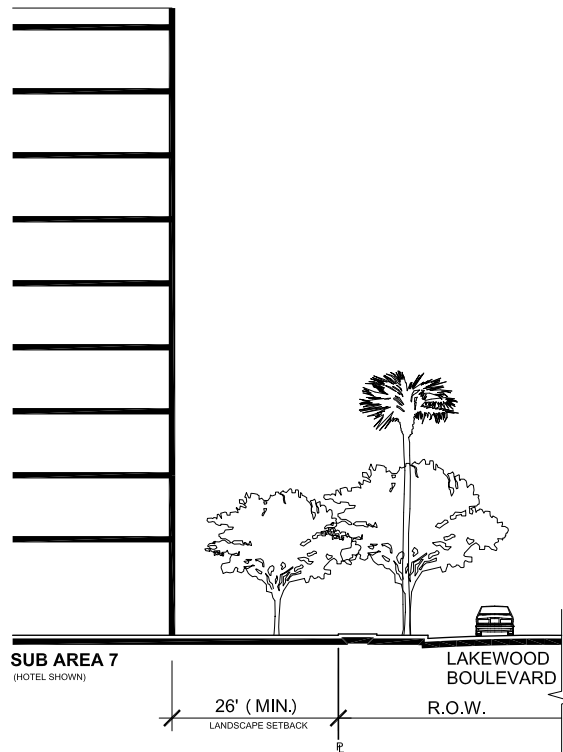

Figure 12 : Section Q-Q

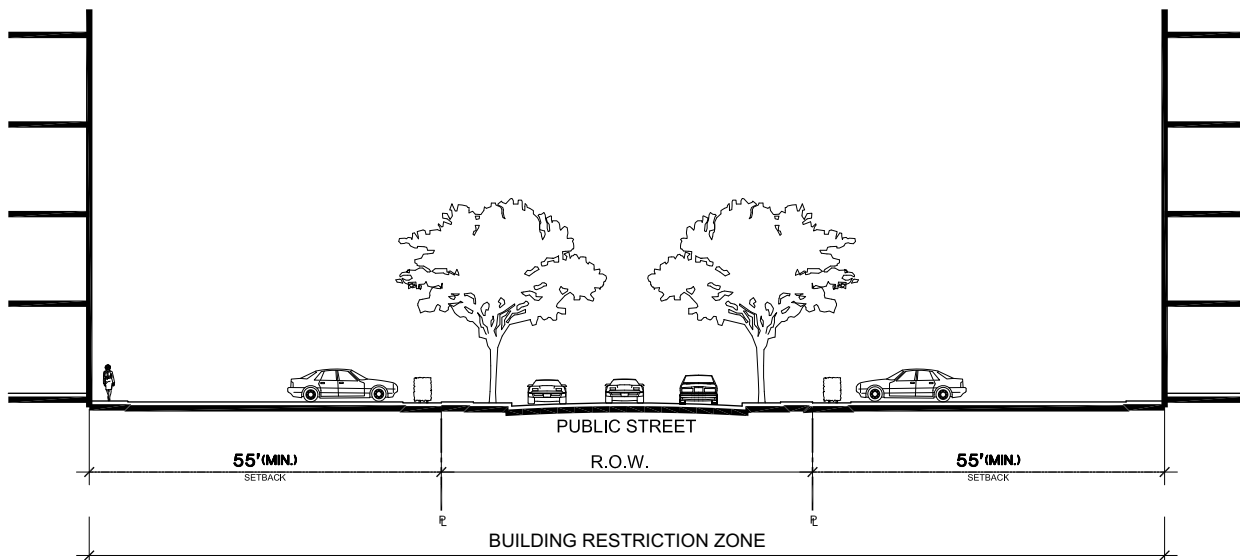
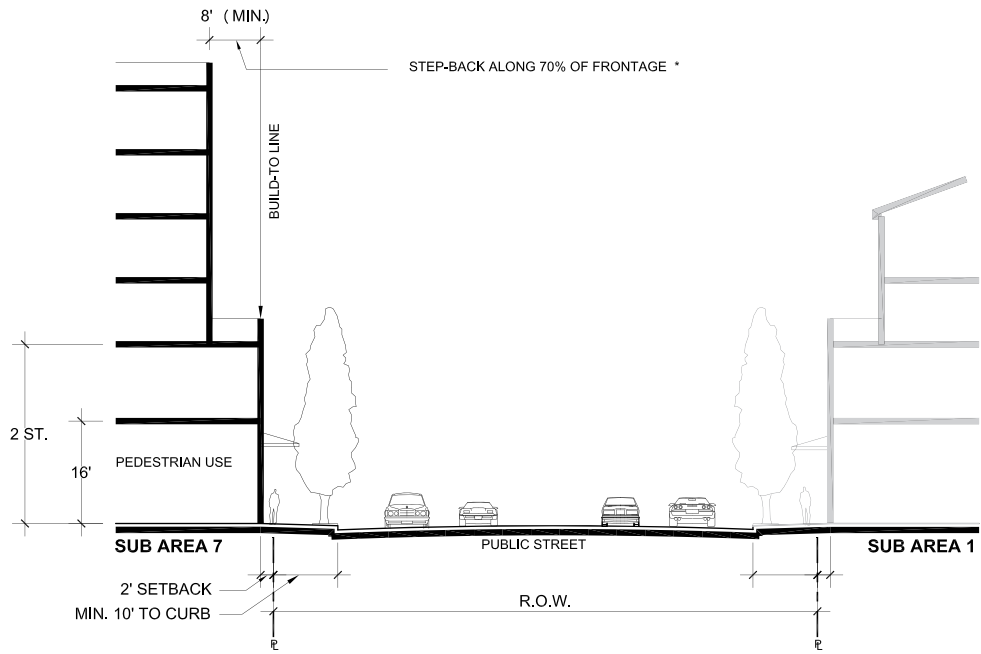

Figure 13 : Section R-R



*NOTE: REFER TO STEP-BACK REQUIREMENTS FOR ADDITIONAL INFORMATION

Figure 14 : Section A-A

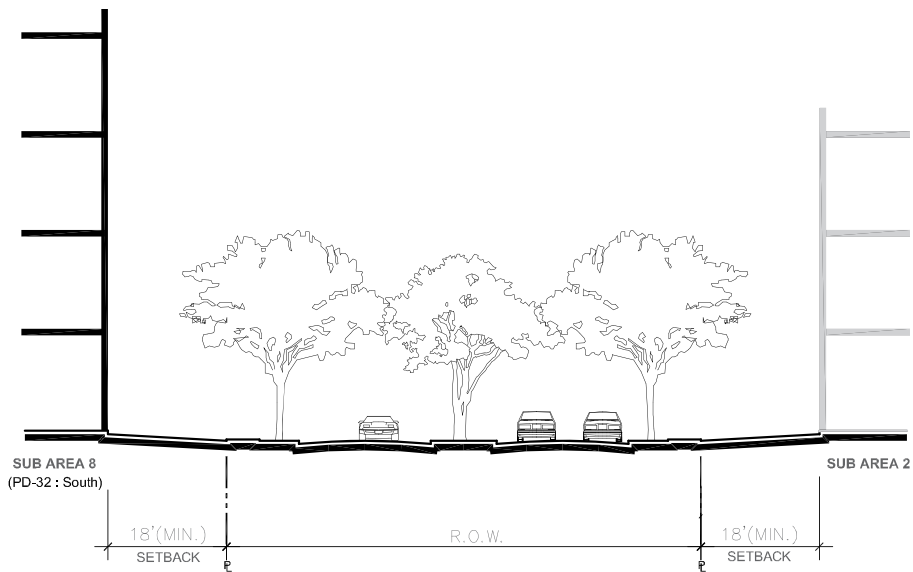

Figure 15 : Section P-P

S u b A r e a 8

Sub Area 8A

This sub area shall be primarily a Research & Development and light industrial zone, along with aviation-related uses south of Conant Street. Uses allowed in Sub Area 7, are also allowed in this Sub Area.

Sub Area 8B

Sub area 8B, also known as the Boeing Enclave, will allow aviation-related uses associated with the existing area to continue. Should current operations of this sub area be discontinued, the area will be developed with uses consistent with Sub Area 8A, and the following development standards shall apply to both.

Continuous Building Edge/ Facade Articulation

Along Cover Street, no continuous building wall shall extend more than 100 feet in width without a facade articulation element. Blank walls are discouraged, and the maximum width of a blank wall without articulation or relief of at least 6 inches in depth shall be 25 feet. Facade articulation shall consist of elements such as expressed structural bays, pilasters, moldings, recessed wall panels, or display features to create visual interest.

Vehicular Driveway Access

Future access streets and driveways are encouraged to reinforce the grid imposed by the street hierarchy of the Plan Area. This requirement may be waived through the Site Plan Review process if necessary.

Boeing Enclave Screening

The 48-acre Boeing Enclave, in which a variety of aircraft production-related uses presently operate is expected to remain operational during project construction for all or a portion of the development period until Boeing no longer has use for the Enclave in its current capacity. While in operation, an evergreen landscape hedge shall be installed on the eastern side of the Enclave and on the north side of the fence surrounding the Enclave to provide screening.

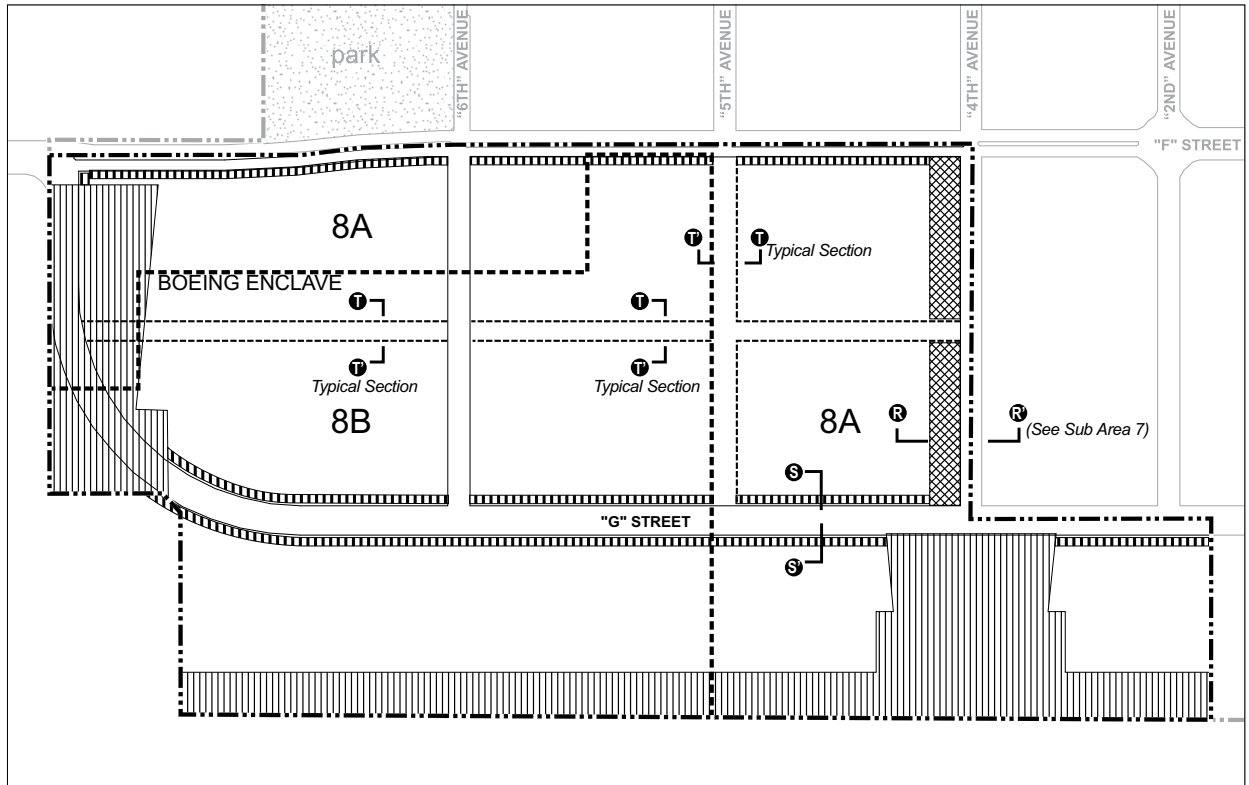

 55' Minimum Building Setback along "4th" Avenue

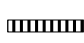
 18' Minimum Building Setback along "F" & "G"

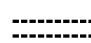
 Preferred Location of Access Streets

 Building Restriction Zone *
(Parking may be permitted subject to City approval)

* For Reference Only :Based on the City of Long Beach Airport Runway Approach

Figure 16 : Sub Areas 8A and 8B

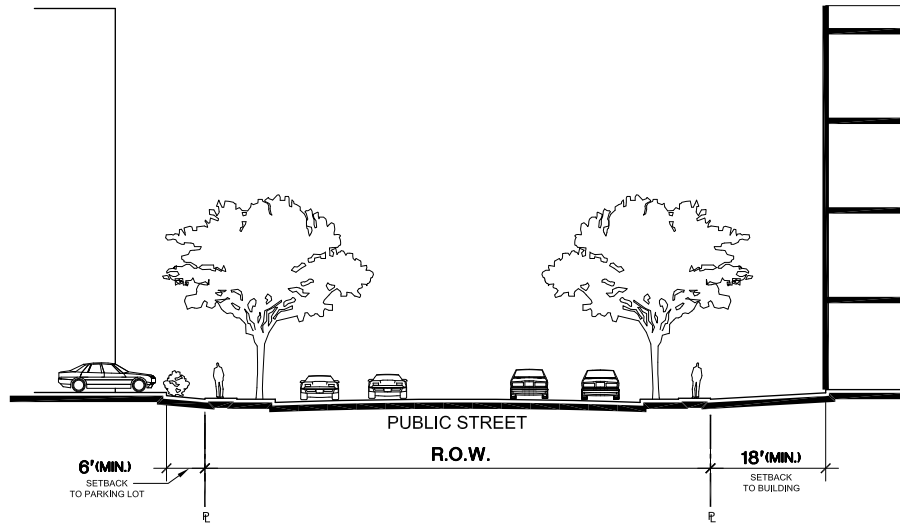

Figure 17 : Section S-S

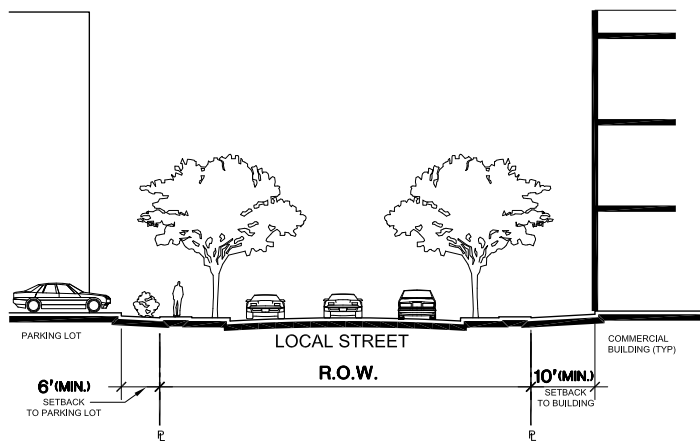

Figure 18 : Section T-T

S t a n d a r d s - D i v i s i o n I V

A p p e n d i x

Appendix

Master Street Tree Plan

The Master Street Tree Plan provides the suggested tree species, size, and spacing for the outlined streets below. Builder is to submit Landscape plans to the Director of Public Works for approval. The Director of Public Works may approve alternate species. Submittal requirements shall comply with the provisions of Chapter 21.25 (Specific Procedures) of the LBMC.

Frame Work Streets

Cover Street (Mixed Use - Lakewood Boulevard to Worsham")

Pyrus calleryana 'Bradford' - Bradford Pear

36" Box - 30' o.c.

Phoenix dactylifera - Date Palm

18' BTH - 30' o.c.

Cover Street (Commercial/Industrial - Worsham to Paramount Blvd.)

Quercus Ilex - Holly Oak

36" Box - 35' o.c.

Conant Street

Magnolia grandiflora – Magnolia

36" Box - 35' o.c.

Worsham Avenue

Jacaranda mimosifolia - Jacaranda

36" Box - 35' o.c.

Schaufele Avenue

Ulmus parvifolia – Chinese Elm

36" Box - 40' o.c.

Industrial Sub Streets

Stineman Avenue

Ulmus parvifolia - Chinese Elm

24" Box - 40' o.c.

Setback

Eucalyptus species - Eucalyptus

24" Box - 25' o.c.

Melaleuca quinquenervia - Cajeput Tree

36" Box - 25' o.c.

Pinus species - Pine

36" Box - 30' o.c.

Tristania conferta - Brisbane Box

24" Box - 25' o.c.

Edges

Lakewood Boulevard

Pyrus Calleryana 'Bradford' - Bradford Pear

36" Box - 30' o.c.

Phoenix dactylifera - Date Palm (Where Height Restrictions Permit)

18' BTH - 30' o.c.

Golf Course Edge

Eucalyptus species - Eucalyptus

24" Box - 30' o.c.

Melaleuca quinquenervia - Cajeput Tree

24" Box - 25' o.c.

Pinus species - Pine

24" Box - 30' o.c.

Airport Edge

(Due to height restrictions edge will be screened with vines.)

Distictis buccinatoria - Blood Red Trumpet Vine

15 gallon - 15' o.c.

Lonicera japonica - Japanese Honeysuckle

15 gallon - 15' o.c.

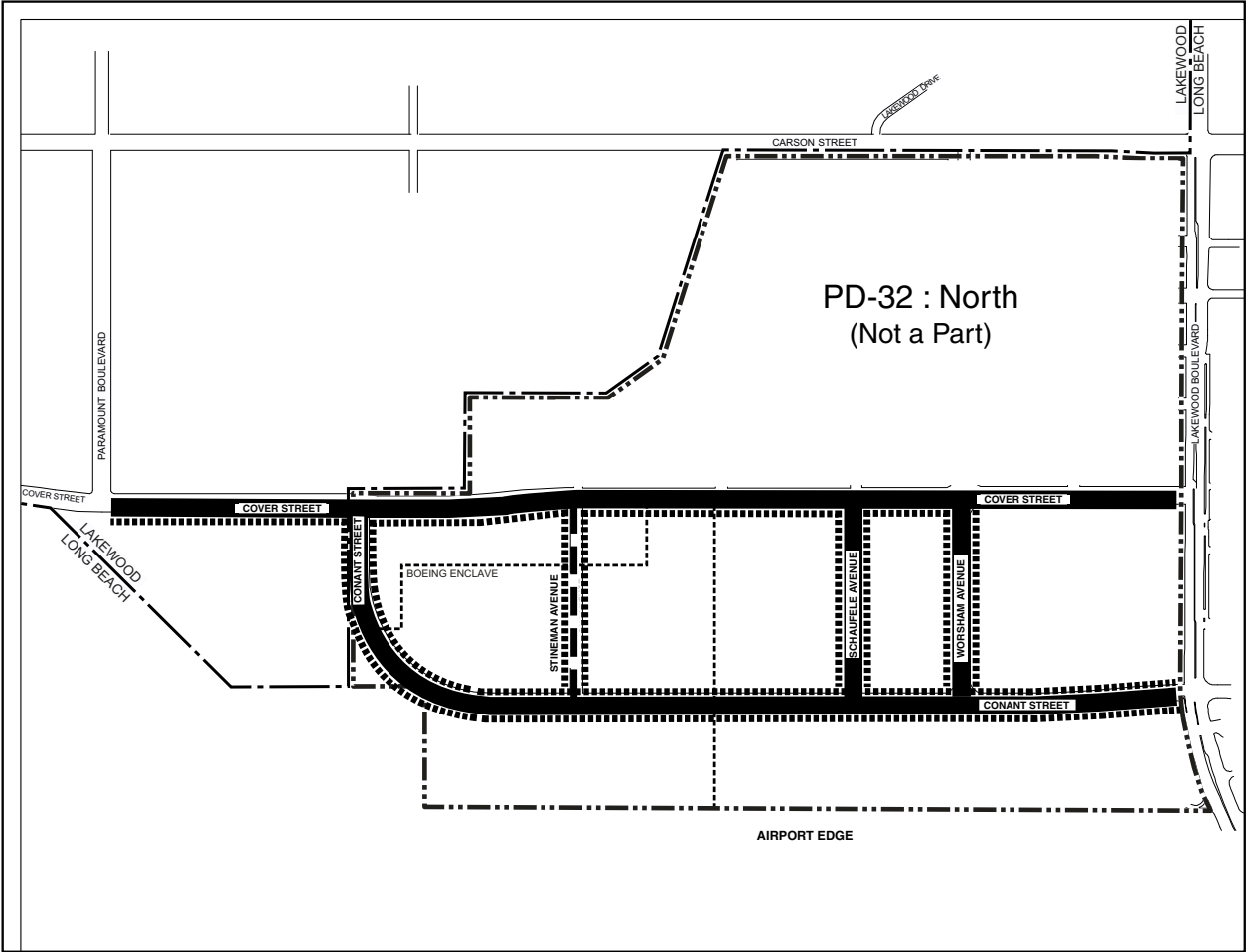

Figure 19 : Master Street Tree Plan