



Site Plan Requirements

CITY OF LONG BEACH DEPARTMENT OF DEVELOPMENT SERVICES
333 W. OCEAN BLVD., 4TH FLOOR, LONG BEACH, CA 90802
INFORMATION (562) 570-6651 FAX (562) 570-6753

A Site Plan is a plan drawn to scale showing the uses and structures proposed for a specific parcel of land and adjoining uses. A Site Plan should include the following information:

1. Lot lines and dimensions.
2. Location of existing and proposed buildings properly dimensioned from property lines.
3. Location of buildings on adjoining and abutting lots with note as to height in stories.
4. Uses of adjoining and abutting lots.
5. All parking and loading facilities showing stalls, access, circulation, docks, ramps and curb cuts and all fences dimensioned.
6. Locations of all trash containers.
7. All existing and proposed easements.
8. All setback lines, properly dimensioned. All contiguous and adjacent properties, streets and alleys, showing centerline and both curb lines, street widths, right-of-way lines and street names.
9. Lot size, lot coverage, building area (by floor) and total floor area to lot size ratio.
10. Site Plan shall be to scale with north arrow.

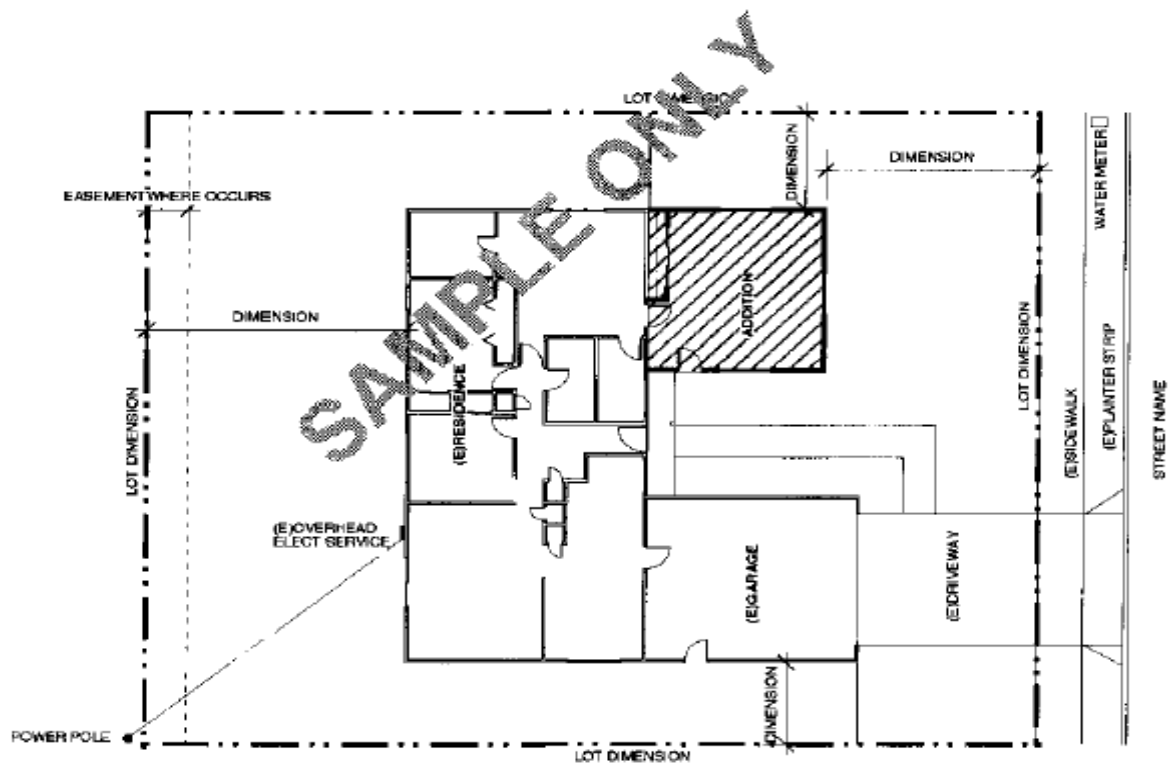

This information is available in an alternative format by request to the Development Services Center at (562) 570-6651 or (562) 570-6793 TDD - Visit our website at lbsd.longbeach.gov